

With Our Temples

Temple Happenings

Beth El V'Shalom

- Sept. 7 - Religious School Begins, K - 7th Grade
- Sept. 9 - Basic Judaism, 7:30 p.m.
Conversion Group, 9:00 p.m.
- Sept. 10 - Sisterhood Luncheon, 11:30 a.m.
- Sept. 14 - Men's Club Breakfast, 10 a.m.
Religious School Begins, 8th - 12th Grade
- Sept. 19 - Community Shabbat Service, 8 p.m.
- Sept. 17 - Selichot Service, 11:30 p.m.
Social Activities, 9 p.m. till --
- Sept. 29 - Sisterhood Board Meeting, 10 a.m.
- Sabbath Eve Services, Fridays at 8 p.m.
- Sabbath Morning Services, Saturdays, 10:30 a.m.

Israel

- Sept. 7 - Men's Club Breakfast, 10:30 a.m.
- Sept. 10 - Sisterhood Meeting/Luncheon
- Sept. 12 - Oneg Shabbat honoring Lila Josephson
- Sept. 17 - Selichot Services

Temple Israel Sisterhood Adopts A Family

As part of a community service project, Temple Israel Sisterhood has "adopted" a Jewish single parent family with three children. Jewish Social Services selected the family and will serve as the intermediary with Sisterhood. The family's identity will remain anonymous.

The Sisterhood will be responsible to help provide them with food, clothing and gifts for special occasions. Anyone wishing to contribute may do so.

This is the first of many social action projects to be supported by Sisterhood. We look forward to helping the community in a variety of ways throughout the year.

— Susan Rabinovich

A Small Investment, But A Large Return

Would you like to make a difference in the lives of homeless women and children? Provide them a place to stay during cold winter nights?

These people need you. Ask how you can help Temple Israel's Shelter Program. For more information call Linda Binnick, 552-1435 or Rabbi Marc Wilson, 376-2796.

DEEDEE DAUMIT

Top Producer For 1985



OFFICE 333-5700
HOME 366-8648

Two names you can trust in Real Estate

Alyce Walker
REALTORS

Happy New Year from Our Advertisers

Bar/Bat Mitzvahs



Temple Beth El V'Shalom

- Sept. 13 - Keeland Francis, daughter of Linda Francis and Elvin Francis.
- Sept. 20 - Seth Rosenberger, son of Mr. & Mrs. James Rosenberger.
- Sept. 27 - Marissa Crown, daughter of Mr. & Mrs. Richard Crown.

Temple Israel

- Sept. 5 - Philip Kornhauser, son of Mr. & Mrs. Martin Kornhauser
- Sept. 12 - Sharon Bernat, daughter of Mr. & Mrs. Eliot Bernat
- Sept. 19 - Ben Frank, son of Mr. & Mrs. Melvin Frank

An Invitation

All Temple Israel pre-school students, graduates, families and friends of Lila Josephson are cordially invited to an Oneg Shabbat at Temple Israel on September 12 to honor her for her years of dedicated service to the Temple's nursery school.

Home Health Care For Your Pet



Charlotte Mobile Veterinary Clinic
Hardin E. Rubin D.V.M.
HOUSE CALLS BY APPOINTMENT
CALL 393-AVET (2838)

shalom park

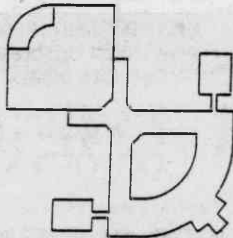

DEDICATION WEEKEND
SEPTEMBER 19-21

Friday 8 PM Joint Service at Beth El V' Shalom
Saturday 7 PM Donor Gala at Shalom Park

Sunday 11 AM School Dedication at Shalom Park 1-4 JCC Carnival at Shalom Park Alvin Levine Gymnasium

GREETINGS AND BEST WISHES FOR A HAPPY NEW YEAR

Harry and Bryant Co.

Funeral Directors Since 1883

500 Providence Road

332-7133

B'nai B'rith's New Nursing Home Insurance protects you against the single greatest threat to your life savings.

"When it comes to insuring against the single greatest threat to their life savings and emotional reserves—the costs of long-term care—Americans have no protection."
Hearing before the Special Senate Committee On Aging

B'nai B'rith's new nursing home plan is designed to help meet the reality of today's staggering nursing home costs. This affordable plan can protect your savings and income:

- A Choice of Benefits Up to \$60 Per Day
- A Home Health Care Benefit is Included
- 2 and 3-Year Plans Available
- Equal Coverage for Your Spouse
- All B'nai B'rith Members Between the Ages of 50 and 79 May Apply (We enroll new members.)

Don't Be Confused!

Medicare and private supplements will not pay for your long-term health care costs. A one year's stay in a private nursing home can cost between \$20,000 and \$50,000, and there are no government programs to help you pay the bills.

B'nai B'rith Members' Insurance Program
Underwritten By:

MSNY THE MUTUAL LIFE INSURANCE COMPANY OF NEW YORK
FINANCIAL SERVICES 1740 BROADWAY NEW YORK, NEW YORK 10019

For more information, contact:

gene Goldberg CLU
Chartered Financial Consultant

900 Baxter Street, Suite 120
Post Office Box 36448
Charlotte, N.C. 28236
(704) 372-3331

YES, I'm interested in B'nai B'rith's New Nursing Home Insurance Plan. Please contact me personally or by phone.

Name _____
Address _____
City _____ State _____ Zip _____
Home Phone _____ Age _____