

Visting Artist, Elga Jones, To Perform Thurs. Evening

The final performance of the Women's Artist Series sponsored by the Chowan Arts Council and College of The Albemarle will feature lyric soprano Elga Jones at 8 o'clock on Thursday evening (tonight) at the Edenton Methodist Church on Virginia Road.

Miss Jones, a 1982 Visiting Artist at Catawba Valley Technical College in

Hickory, specializes in opera, oratorio, and recital. She has several years of college-level teaching experience in applied voice. The artist also performs with her brother and sister-in-law as the Cantilena Ensemble.

She began her career after earning bachelor and masters degrees in vocal performance from the

University of Tennessee. Later, she was accepted into the Professional Studies program at the Juilliard School, studying under former Metropolitan Opera star, Eleanor Steber. Miss Jones has dedicated herself to capturing

audiences who attend her concerts and recitals to experience her outstanding qualities. She has sung roles as "Violetta" in "La Traviata" with the Nassau Long Island Symphony in New York; "Michaela" in "Carmen" with the Brevard

Music Center in North Carolina; the oratorios "Haydn Creation" with the Spartanburg Symphony in Clinton, South Carolina; and "Messiah" with North-eastern Bible College in Essex Falls, New Jersey.

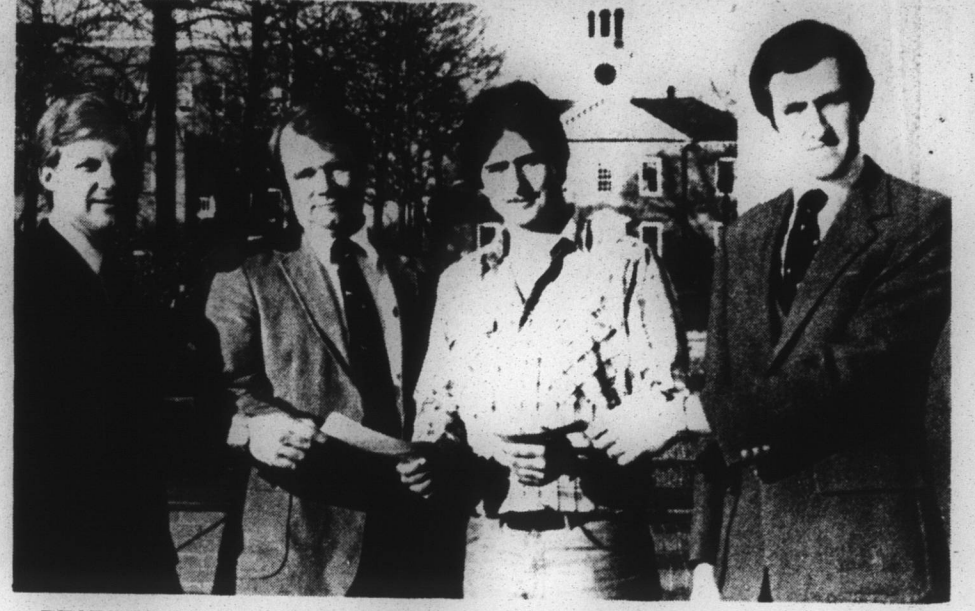

RECEIVES SCHOLARSHIP FOR FARMING COURSE — Wilbur Byrum, second from right, received a scholarship for a two-week short course in modern farming sponsored by the N. C. Banker's Association. Presenting checks to him are: Jim Ball, left, County Key Banker; Mac Self, second from left, City Executive with Tarheel Bank; and Bruce Gilliken, right, City Executive with Peoples Bank. Sponsoring Byrum along with them is Home Feed and Fertilizer.

Health Department Schedule

The Chowan County Health Department announces its clinic schedule for February. The Health Department is located at 109 E. King Street in Edenton (482-2511). The hours are from 8 A.M. - 5 P.M. weekdays. Venereal Disease clinic is at any time or any day on a walk-in basis. All other clinics except general clinics are by appointment only.

- 3 Eye clinic (A.M.) Family Planning (P.M.)
- 4 Multiphasic clinic (all day)
- 5 Teen clinic (A.M.) General clinic (P.M.)
- 8 Child Health clinic (all day)
- 9 Maternity clinic (P.M.)
- 10 Family Planning (P.M.)
- 11 Multiphasic clinic (all day)
- 12 General clinic (P.M.)
- 16 Pediatric clinic (P.M.)
- 19 General clinic (P.M.)
- 22 Child Health clinic (all day)
- 23 Orthopedic clinic (A.M.)
- 24 Family Planning clinic (all day)
- 26 WIC (all day); General clinic (P.M.)

CHOWAN ARTS COUNCIL HOLDS MEMBERSHIP DRIVE — February is membership drive month for the Chowan Arts Council. Left to right is Blanche Woodall, a member of the membership committee; Francis Inglis, charter member and first chairman of the Chowan Arts Council; Tom Phillips, chairman of the Chowan Arts Council Board of Directors; and Marie Pierce, a member of the membership committee.

Arts Council Urges Membership

The Chowan Arts Council is conducting its annual membership drive during the month of February. If you are interested in the promotion and encouragement of the arts in our community, consider joining the Chowan Arts Council this year. Your membership fee of \$5 mailed to Chowan Arts Council, Membership Chairman, P.O. Box 341, Edenton N. C. 27932, will help make possible more programs such as those offered in the past as well as some new and different ones.

Last year, the Chowan

Arts Council held Art and Craft Shows during the Edenton Pilgrimage and the Peanut Festival; co-sponsored a performance of "The Toy Shop" by the North Carolina Opera for grades K-6; sponsored two performances by the Tidewater Ballet for grades 9-12; sponsored the formation of the Albemarle Pops Orchestra; sponsored the children's poster contest for the Edenton Tea Party Celebration; sponsored an exhibit by artist Betty Harris and two concerts by guitarist Michael Chapelaine.

This year's projects, so far, have included hosting the reception following the performance of the North Carolina Symphony and co-sponsoring, with College of the Albemarle, a series of four performances by noted women artists. Plans for the future include more art shows and programs, a spring festival, and an arts newsletter.

Chowan Arts Council members urge you to join them in becoming a part of the planning, the participation, and the enjoyment of the arts in our community.

Tarkington's

All Fall & Winter Dresses
Marked Down Again

1/3 to 1/2
1981-82 styles

Fleece Robes & Brush
Nylon Sleepwear

reduced 1/3

Stull Presented Award

Richard J. Stull, president-emeritus of the American College of Hospital Administrators, was presented the N.C. Hospital Association Distinguished Service Award today in Raleigh at ceremonies opening the 1982 Winter Meeting of the Association. The award is the highest bestowed by NCHA.

Stull was educated at Duke University, and earned a certificate in hospital administration at Duke University Medical School. He joined ACHA in 1965 as executive vice president, assumed the duties of president in 1971,

Continued On Page 9-A



Accuracy Counts!

We follow orders to the letter ... guarantee all jobs!

The Chowan Herald
482-4418



Fish Market Etcetera
427 S. Broad St. Edenton, NC
PHONE - 482-2001

Before The Sweetheart Ball
enjoy a Sweetheart Special

Steak for Two

Includes: Vegetable, Roll, Our Popular Salad Bar, & Beverage

\$14.75

SEALED BIDS TO BE OPENED FEB. 25, 1982
FOR CREWS AND DETAILS CONTACT:
TONY WEBB, CONSULTING FORESTER — BROKER
482-8558

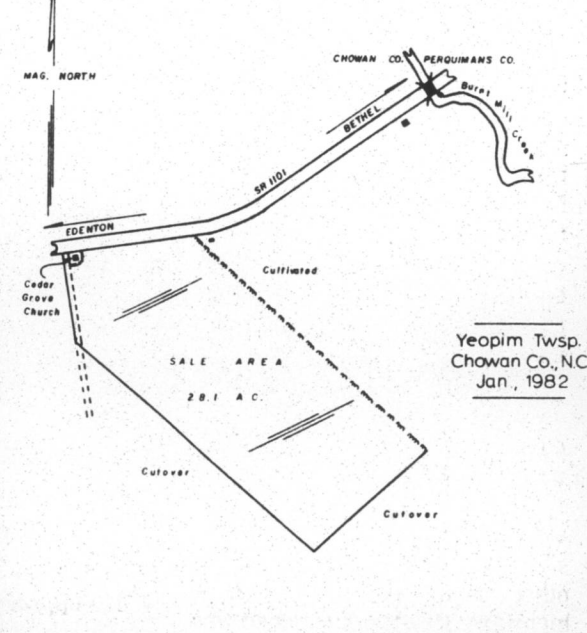

Yeopim Twp., Chowan Co., N.C.
Jan., 1982

SCALE: 1 inch = 400 feet
DRAWN BY: Tony Webb, R. F.
REFERENCE: Plat. By C.C. Webb, R. L.S.

AUCTION SALE

OF VALUABLE FARM EQUIPMENT

FRIDAY, February 19, 1982 -- 10:00 A.M.

SALE LOCATED: ELTON BOSWELL FARM: 12 Miles North of Edenton, N.C. off Hwy. 32, Turn at Small X Roads on State Route 1222. FOLLOW AUCTION SIGNS.





TRACTORS

- * Ford Tractor - 9000 - Diesel
- * Ford Tractor - 8800 - Diesel
- * Ford Tractor - 8000 - Diesel
- * Ford Tractor - 7600 - Diesel
- * Ford Tractor - 6600 - Diesel
- * Ford Tractor - 4000 - Diesel
- * Ford Tractor - 1600 - Diesel with Rotary Mower #930
- * John Deere - 6000 - Diesel - Hi-Boy Sprayer - 14 Row Boom
- * John Deere Tractor - 3010 - Gas

HARVESTING EQUIPMENT

- * I.H.C. Grain Combine - #815 - Diesel - Cab and Air - 4 Row Corn and Bean Header (Hydrostatic)
- * 2-Liston Peanut Combines - #1500
- * Liston Peanut Combine - #1580
- * 2-Roanoke Drying Units - 6 Trailers Each
- * Long Drying Unit - 4 Trailers
- * John Deere Cotton Picker - #22 - 1 Row
- * John Deere Cotton Picker - #22 - 1 Row (Parts Only)

MACHINERY

- * 2-Burch Disc - 4 Row
- * I.H.C. Disc - 4 Row
- * John Deere Bedders - 4 Row with Hyd. Row Markers and Gauge Wheels
- * W.A. Bedders - 4 Row - with Chisel and Hyd. Row Markers and Gauge Wheels
- * 2-Sets Ford Middlebusters - 4 Row - Double-Bar - with Gauge Wheels
- * 2-Liston Rotary Cultivators - 4 Row
- * John Deere Cultivator - 4 Row
- * Pittsburgh Cultivator - 4 Row
- * Stalk Cutter - 4 Row
- * McClellny Rotary Hoe - 4 Row - P.T.O. with Gandy Hoppers
- * Ferguson Rotary Hoe - 4 Row - P.T.O.
- * Ferguson Peanut Lifter - 6 Row - Hyd.
- * Noble Harro - All - 4 Row
- * Ferguson Row Shapers - 4 Row
- * Ford Chisel Plow - 12 Tongue
- * Paulk Sower - 4 Row

TOBACCO EQUIPMENT

- * Long Harvester with 3 Rack Trailers
- * 4-Roanoke Barns - 2 Tiers with Racks
- * Roanoke Barn - 3 Tiers with Racks
- * New Holland Trans-Planter - 2 Row Trailer-Type Hyd.
- * Vann Harvester Aid - Pull-Type (HandPic)
- * Cultivator for 48 Inch Rows with Side Dressers
- * Row Shaper - 2 Row - (48 Inch Row)
- * Plant Bed Irrigation System with Pump and Motor
- * Tobacco Trailers - (Old Type)

TRUCKS

- * 1977 Chev. - 2 Ton - C-60 - 8 Cylinder - with Johnie Gregory 16 Ft. - Dump Body - 2 Speed - (19,076 Miles)
- * 1968 Chev. - 2 Ton - 8 Cylinder - with Johnie Gregory 16 Ft. Body - 2 Speed - (40,112 Miles)

* MANY OTHER ITEMS TOO NUMEROUS TO MENTION

TERMS: CASH OR GOOD CHECKS
NOT RESPONSIBLE FOR ACCIDENTS

NOTE: ALL THIS EQUIPMENT HAS BEEN WELL KEPT AND IN GOOD CONDITION. IF YOU ARE LOOKING FOR GOOD EQUIPMENT, DON'T MISS THIS SALE.

Sole Authorized By:
ELTON BOSWELL
Edenton, N.C.
Phone: 482-5958
Hwy. 221 N451

Bonded License #90
Auctioneer
HAROLD WINKLOW
Hertford, N.C.
Phone: 297-2658

Lunchroom Schedule

Continued From Page 3-A

cinnamon toast, and milk. Pizza, carrot strips, green beans, cherry crisp, and milk.

Tuesday — Orange juice, bacon crisp, hot cereal, and milk. Sloppy joes on bun, french fries, ketchup, buttered corn, and milk.

Wednesday — Orange juice, sausage biscuit, and milk. Roast turkey and dressing, giblet gravy, sweet potatoes, mixed greens, rolls and milk.

Thursday — Fruit cup, cheese toast, and milk. Beef vegetable soup, sandwiches, crackers, fruit cup and milk.

Friday — Orange juice, doughnuts, and milk. Bar-bued chicken, potato salad, green peas, rolls and milk.

Ryan's Grove Service Slated

Continued From Page 2-A

should contact their local chamber of commerce. Chambers of Commerce will be coordinating each county's effort through Jinger Mitchell of the North Carolina Travel and Tourism Division, 430 North Salisbury Street, Raleigh, North Carolina 27611, telephone 919-733-4171.

Between 11 and 15-million visitors are anticipated to attend the World's Fair during its six months of operation from May 1 through October 31.

Engagement Announced

Continued From Page 3-A

ward R. Smith, Sr. of Suffolk, Va. and Mrs. Marie Bennett of Raeford, N.C. He is a graduate of Radford College in Radford, Va. where he received his bachelor of science degree. He is presently employed with a construction firm in Hampton, Va.

An August wedding is planned.



Happy Valentine's Day

from Courtney's
downtown edenton

SPECIAL OFFER NO. 1

1 FREE SNOOPY OUTFIT
WITH \$5 PURCHASE
OF SNOOPY ITEMS.

PLUS

SPECIAL OFFER NO. 2

2 FREE SNOOPY OUTFITS
WITH \$15 OR MORE
OF SNOOPY ITEMS.

NEW ARRIVALS DAILY INCLUDING:

- Landlubber Jeans & Shorts
- Nantucket Blouses
- Skyr Skirts & Blouses
- Brittonia Sportswear

- Plus -

Special Handcrafted Valentine Gifts!