

The News-Record

NON-PARTISAN IN POLITICS
BOX 367 MARSHALL, N. C. 28753

PUBLISHED WEEKLY BY ENTERPRISE PRINTING CO.

Second-class privileges authorized at Marshall, N. C. 28753

JAMES I. STORY, Editor

Subscription Rates In Madison		Subscription Rates Outside Madison	
15 Mos.	\$4.50	15 Mos.	\$9.00
12 Mos.	4.00	12 Mos.	8.00
8 Mos.	3.50	6 Mos.	6.00
6 Mos.	3.00	3 Mos.	4.00
4 Mos.	2.50		

(Add 4 percent tax For All in No. Car.)
 AIR MAIL.....40c Per Week

I WOULD LIKE TO SUBSCRIBE TO THE NEWS-RECORD

Name _____

Address _____

Zip _____

Cash Money Order
 Check Bill me at this address

Revival At Trinity

A series of revival services will begin at the Trinity Baptist Church (near Mars Hill on Old NC 213) on Sunday, August 24 and will continue through Friday, August 29. Services will be held nightly at 7:30 o'clock.

The Rev. E.S. Morgan will be the visiting evangelist. Mr. Morgan is a native of Madison County and is pastor of the Newbridge Baptist Church.

The Rev. Homer Tomberlin, pastor, cordially invites everyone to attend the services.

Eyes Examined
 Glasses Fitted
 —by—
DR. LOCKARD
 FRIDAYS
 8 A.M. to 12 NOON
ROBERTS BUILDING
 MARSHALL, N.C.

Letter To The Editor

Dear Jim:

Please allow me a little space in The News-Record to express my appreciation to all those who have been so kind and cooperative during the past 6 1/2 years I have been with Mainstream in Madison County.

During these years I have grown to love the people of your county and have enjoyed working with them. I will never forget the friendships I have made and will try to visit there whenever possible.

I also deeply appreciate your friendship and wish for you and The News-Record continued success.

Sincerely,
 TROY GUDGER

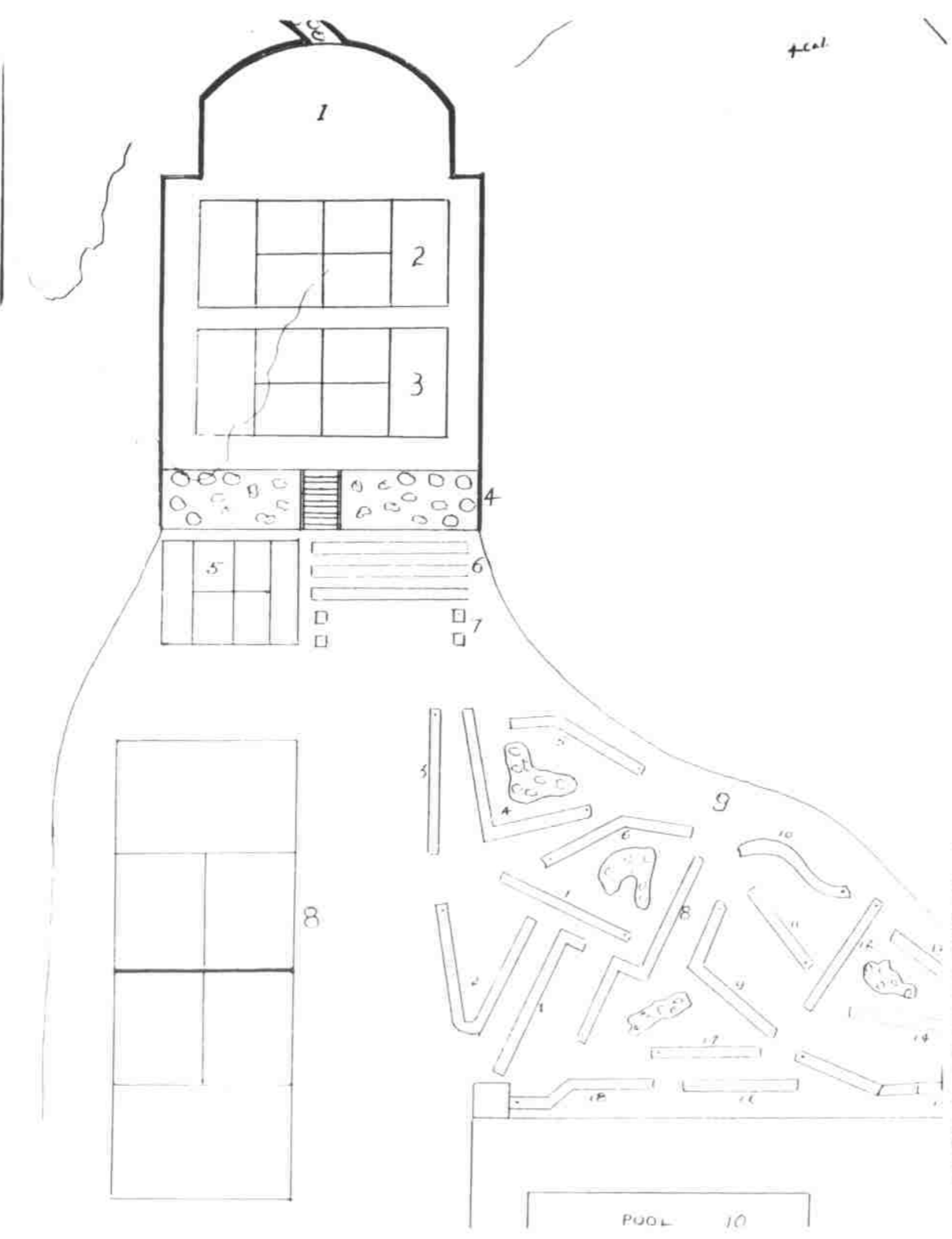

THIS IS A REPRESENTATIVE DRAWING of what the proposed improvement at the Marshall recreation center will look like. It is not to scale nor is it exact; it is only approximate. 1. Open multipurpose area. 2. and 3. tennis courts. 4. Angular cut with informal rock garden, framed in with tall, graceful trees, English Ivy ground cover. Stairs to intermediate level. 5. Badminton court. 6. Shuffleboard courts. 7. Horseshoe pitching alleys. 8. 2 handball, paddleball or tennis practice courts. 9. 18 hole carpet golf course with free form landscape patches wherever possible. All holes will have hazards and-or obstacles which are not shown, exact layout will depend on what room is available. 10. Pool area. The walls around the tennis courts will be of native stone. There will be an access from Skyline Drive at the head of the multipurpose use area. There will also be an access from ground level to the intermediate level. If all the facilities are used at the same time, about 70 people can be enjoying themselves. "Hopefully we will make this a most beautiful development and one that Marshall and vicinity can be proud of," Francis Pizzulo said. (Read Guest Editorial)

Recreation Vital -- Dam Priority

GUEST EDITORIAL
 By **FRANCIS PIZZULO**
 Recreation Leader

Work was started on the tennis courts and recreation center last week, but was stopped almost immediately. Mayor Ponder and the Town Councilmen fully realize the importance of this facility and have given their full support to the project. Unfortunately, our dam has been condemned and the funds which were available now must be used to rebuild the structure. Other avenues of financing have been explored for both the dam and the recreational complex but nothing has been turned up as of now. Naturally, the dam takes precedence and all available funds must be directed to this job.

Our proposed recreation center is much more important than most people might think. It will give our young people somewhere to go and something to do almost all year long. It will also help us attract small industry and hopefully, some tourists. If we hope to raise our living standards we must take some positive steps soon. If we want to keep our young people here, we must show them that we care and are trying to all we can to make life better for them. We must be able to provide jobs at living wages in order to keep them from looking elsewhere.

This is not to say that construction of a recreation center will accomplish miracles, but it will be a start.

Naturally there are some who wish to see Marshall and Madison stay as they are and to some extent, this is understandable, but not always possible. Other towns have tried this and have virtually fallen into ruin. Populations have declined, services have been curtailed, industry has moved out and the quality of life has declined. I am sure that the people of Marshall have too much pride to let this happen.

What we need right now is to raise the money ourselves for this recreational complex. We need the help of each and every person in order to be successful. We need new and fresh ideas for raising the necessary funds. We also need success oriented leadership help.

If you are a leader and want to help or work in any capacity, please contact Francis Pizzulo at 649-2035 as soon as possible. "If you are concerned about your youngsters or teenagers, let me know. If you want a Community Center which will be unique in Western North Carolina, one to be proud of, I want to hear from you. We can work together and show the world that we really do care for ourselves, our young people and our community," Mr. Pizzulo stated.

Mrs. William Pegg Retires

After forty-three years teaching in the public schools, Mrs. Zora Riddle Pegg retired in June. Forty-two years were spent in North Carolina and one in Tennessee.

Mrs. Pegg was born in Spruce Pine, N.C. She began teaching in Mitchell County in the fall of 1931, during the depression days and following her graduation from Mars Hill College. While teaching she continued her college education at Western Carolina University, Appalachian State University, and University of North Carolina at Greensboro.

In 1943 Mrs. Pegg married William F. Pegg of Haverland, Penn. After World War II they lived and taught in Spruce Pine for ten years before moving to Mars Hill. Mrs. Pegg taught seven years in the Buncombe County Schools, seven years at Ira B. Jones School in Asheville, and for the past five years she has been teaching in the Mars Hill Elementary School. Her husband is Director of the Computer Center at Mars Hill College. They are the parents of a son, William F. Pegg, Jr. who is a graduate of Mars Hill College and is entering his third year of graduate studies at Duke University Divinity School in Durham, N.C. He is married to the former Barbara Whinsant of Taylorsville, N.C. who teaches in Neal Junior High School, near Durham.

After forty-three years of school activities, national, state and local professional organizations, church and community affairs, Mrs. Pegg says she will never lose interest in these things which are so much a part of her life. Now she just wants to set her own pace for awhile and perhaps have more time for her family, friends, and hobbies.



County Group Wins In Festival

The Appalachian Folk, a group from Madison County, won first prize in the old time band competition at the Mountain Dance and Folk Festival in Asheville last weekend.

The Appalachian Folk are led by Byard Ray, mountain fiddler from Sodom, Laurel.

Lou Therrell from Mars Hill plays claw hammer banjo. Betty Smith, ballad singer from Marietta, Ga., plays guitar with the group. Vivian Hartsoe of Mars Hill is rhythmic guitarist and Betty Sue Johnson from Chapel Hill plays wash tub bass.

The most recent awards given to individual members of the group are: first prize in old time banjo to Lou Therrell and first prize in ballad singing to Betty Smith at the Asheville festival last weekend; the prize for the most authentic old time fiddle tune to Byard Ray for his rendition of Paddy on the Turnpike, played at the American Folk Life Festival which was sponsored by the Smithsonian Institute in Washington, D. C. in July 1975, and novelty award to Vivian Hartsoe for her tune bow playing at Fiddler's Grove in 1974.

Although Byard Ray is the only member of the group who was born and raised in Madison County, the other members have adopted this county as home. Lou Therrell and Vivian Hartsoe have lived in Mars Hill several years. Betty and her husband Bill Smith own property in Spring Creek and hope to move there soon. Betty Sue Johnson owns a cabin in Shelton Laurel and expects to retire there. The Appalachian Folk are usually introduced as coming from Madison County and in spirit all are from Madison County.

Forget The Hang-Ups Of Washday...

Wear clothes that we have restored to original beauty with special dry cleaning process.

Edwards Cleaners & Drymat
 Main Street
 Marshall, N.C. Phone 649-2333

Principals, Teachers Named For Co. Schools

- Following is a list of principals and teachers for Madison County Schools for the 1975-76 term:
- WALNUT ELEMENTARY SCHOOL** - Jewel Church, Principal. Teachers - Ellsbery Wyatt, Tressalee B. Ramsey, Lena J. Norton, Lucille Burnette, Betty Bradley.
- MADISON HIGH SCHOOL** - J. C. Wallin, Jr., Principal; J. Bruce Phillips, Asst. Principal. Teachers - Peggy Cutshaw, Vivian Diercks, Karen Ponder, Hettie B. Rice, Hazel Suttles, Sandra Tolley, Carol Whitt, Troy S. Harrison, J. D. Wallin, F. N. Willett, Doyle Ammons, Fredrick Anderson, Paul Gunter, Mary Sprinkle, Larry D. West, Bobby D. Franklin, Janet Hall, Cecil Rex Sprinkle, Patricia Waldrop, Ronnie Wallin, Louise Zimmerman, Don Fowler, Leonard D. Hefer, Dorothy B. Shupe, William Stell, Linda McCurry, Roy Reeves, Freida Ponder, Eileen Wood, Elizabeth Clayton, Willa P. Wyatt, Special Education - James Enele Boone, John Fisher and Susan Kiser (Gifted).
- MARSHALL ELEMENTARY SCHOOL** - Clive Whitt, Principal. Teachers - Robert D. Banks, Jaunita Boone, Fred C. Haynie, Phyllis Cooper Moore, Auburn E. Wyatt, Judy Payne, Reva F. Plemmons, Billie J. Redmon, Winnifred R. West, Helen T. Ledford, Viola M. Ramsey, Othella M. Brignun, Mary E. Ward, Donna S. Rice, Nancy Gentry Allen, Sandra E. Briggs, Alexander Farkas, Helen Adams, Kindergarten - Christa T. Wallin, Doris C. Wyatt.
- MARSHALL ELEMENTARY SCHOOL** - Fred I. Dickerson, Principal. James H. Ray, Asst. Principal. Teachers - Lewis W. Ammons, Jr., Peggy A. Thomas, Larry D. Wyatt, Agnes W. Metcalf, Kenneth J. Radford, Brenda D. Gindra, Ruby English, Nina B. Ledford, Gladys Ammons, Lena B. Ray, Ruby C. Wallin, Tommy P. Blackwell, Eva McIntosh, Elizabeth A. Norville, Betty Ballard, Patricia E. Ball, Billie Jean Haynie, Paula M. Ammons, Carolyn Ponder, Janice Pressley, Sadie E. Wallin, Wanda Edmonds, Patsy Hoyle, Edith L. Radford, Judy Wallin, Ruby Anderson, Beverly Hough, Kindergarten - Marie Cody, Shirley Cody.
- LAUREL ELEMENTARY SCHOOL** - Vernon J. Ponder, Principal. Teachers - Harvey Franklin, Ruth T. Landers, Rena W. Shelton, June Plemmons, Linda Gunter, Shirley Metcalf.
- HOT SPRINGS ELEMENTARY SCHOOL** - David Wyatt, Principal. Teachers - Frances L. Ramsey, Mattie Ray Ramsey, Elizabeth Staude, Dorothy L. Chandler, Vera Sumrell, Shirley Jean Franklin, Special Education - Jack Brown.
- SPRING CREEK ELEMENTARY SCHOOL** - Larry S. Plemmons, Principal. Teachers - Howard R. Trimble, Martha F. Kirkpatrick, Isabelle Maynard and Karen B. Brown.

All Types Of **MATERIALS** And Samples Including **VINYL FABRICS** (Plastics or Leatherettes)

FREE ESTIMATES

Will Bring Samples To Your Home

23 Years' Experience

WRIGHT'S UPHOLSTERING SERVICE

Phone 645-3612
 6 Main Street
 P.O. Box 574
 WEAVERVILLE, N.C.

LOANS FOR ANY PURPOSE

new car loans home improvement loans
 recreational vehicle loans educational checkloan
 vacation loans personal loans

First Union National
 "The Advantage Bank"

Marshall, N.C. 649-3515 Weaverville, N.C. 645-4231

REVIVAL

Trinity Baptist Church

Near Mars Hill On Old NC 213

August 24-29 - 7:30 p. m.

Rev. E. S. Morgan, Evangelist
 Native of Madison County, Pastor Newbridge Baptist Church
Rev. Homer Tomberlin, Pastor

You Are Invited — If You Can't Come Please Pray For Revival

Health News
 By R.W. Thum

How To Treat a "Delightful" Itch!

If you haven't experienced the delightful itch from a good case of poison ivy, you haven't lived. Seriously, though, the usual treatment of washing affected areas several times daily and applying some form of calamine lotion sometimes just isn't enough. The itch persists.

For mild cases I'd recommend a cool wet compress or a paste of baking soda covered by gauze. To prevent reinfection I'd also launder exposed clothing carefully immediately after wearing.

A poison ivy outbreak will normally last two or three weeks. However, you should expect a longer duration if the blisters become infected. Consult your doctor to make sure this doesn't happen.

Bring Your Next Prescription To Us After You See Your Doctor. Our Service Is Unbeatable!