

# ON THE MOVE

Over the summer Guilford moved the location of several administrative offices to different buildings. Lines are numbered on the map to show where an office originally was and where it now is located:

1. The office of Internships and Bonner Scholars moved from Worth House II to the basement of Founders Hall.
2. The offices of the Academic Dean and the Provost moved from New Garden Hall to the second floor of Founders Hall.
3. The office of Admissions moved from Hendricks Hall to the first floor of New Garden Hall.
4. The office of Public Relations moved from the house by the lake to Hendricks Hall.
5. The offices of the Career Center and Financial Aid both moved from Founders Hall to New Garden Hall, second floor.

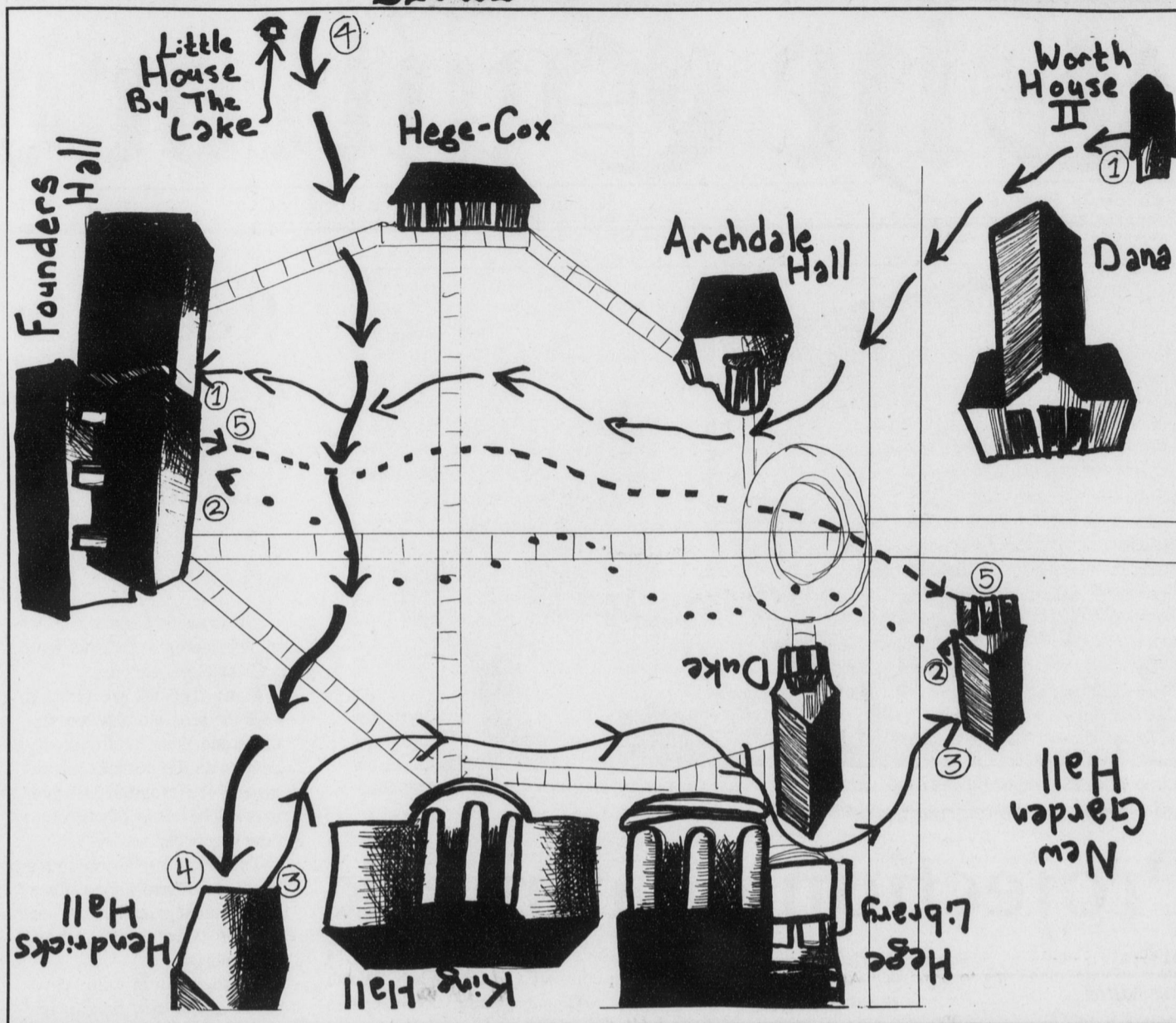

## UNION WELCOME WEEKEND

Friday: 8:30 PM Selected Hilarity -Sternberger  
 10:00-1:00 QUAD Dance  
 Saturday: 12:00-4:00 GAMES: Sumo Wrestling, Bungee Run, Orbitron, Food & Drink  
 9:00-11:00 Concert "Breakfast Club" Early 80's Music

## Senate Elections

ELECTIONS FOR RESIDENCE HALL, DAY-STUDENT, AND CLASS REPRESENTATIVES TO THE GUILFORD COLLEGE COMMUNITY SENATE WILL BE HELD ON THURSDAY, SEPTEMBER 8TH. BALLOTS MAY BE CAST IN FOUNDERS HALL LOBBY FROM 7:30 AM UNTIL 7:30 PM.

STUDENTS RUNNING FOR A POSITION MUST COMPLETE AND RETURN AN APPLICATION TO THE INFORMATION DESK, FOUNDERS HALL, BY NOON ON THURSDAY, SEPTEMBER 1ST. APPLICATIONS WILL BE AVAILABLE AT THE INFORMATION DESK BEGINNING AT NOON ON WEDNESDAY, AUGUST 24TH

### The Guilfordian

Co-Editors in Chief.....Daphne Lewis  
 .....Caroline A. Wolfe  
 Adviser.....Jeff Jeske  
 News Editor.....Nat Grey  
 Perspectives Editor.....Hardy Wallace  
 Features Editor.....Kitson Broadbelt  
 Sports Editor.....Joe Wallace  
 Personnel Manager.....Kiley Holder  
 Copy Editing.....Rebecca Chamberlin  
 Circulation/Subscription...Kinsey Gimbel  
 Advertising/Business.....Teddy Kolev,  
 .....Brian Lane  
 Photography Editor.....Heather Glissen  
 Staff Contributors....Shingai Jaravaza,  
 Wade Tomlinson, Rich Ewell, Jocelyn Newsome, Jodie Hargus, Amy Leacy, Kevin Falia, Lauren Goforth, and John Carbaugh

Staff meetings are held weekly in the Passion Pit, second floor, Founders Hall, Monday evenings at 8 o'clock. All are welcome.

### Editorial Policy

Opinions expressed in editorials and letters to the editor do not necessarily reflect the views of the staff and editorial board.  
 The editors reserve the right to edit all submissions for length, style, and taste.

### Submissions

The Guilfordian encourages submissions. Typed articles and letters are due by 7:00 PM., Sunday. Letters are limited to 250 words or less and must include author's name, phone number and P.O. Box. Write to:  
 Editor  
 P.O. Box 17717  
 Guilford College,  
 Greensboro, NC, 27410.  
 E-mail:  
 Guilfordian@rascal.guilford.edu