

J. R. Alexander's Dunovant Place, on Broad River, Near Chalkville

**This Property Will
be Sold Publicly or
Privately if Satisfactory
Prices
Can be Obtained**

**Chester County
CITY PROPERTY.**
No. 319—Large brick sale and livery stable in Chester, water works and electric lights. Elegant mule pens, box and open stalls, feed and harness rooms, fine stand for livery and trading, as Chester has a large country trade in addition to three railroads. The land measures 140 by 155 feet and should be worth almost the price asked for the property. Terms one-fourth cash, balance one, two and three years at 6 per cent. This is elegant property and is now renting for \$27.50 per month, which is 6 per cent interest on \$2,900, and constantly increasing in value.
Stable, W. W. Brice, Chester, S. C.
No. 376—5 lots in Chester; No. 2, 72x213; No. 4, 130x155; No. 6, 72x126; No. 8, 72x114; on Epworth street.
Vacant lots, Jno. G. Cousar, Chester, S. C.
No. 635—Two 2-story brick stores fronting west on Main street, Chester, population 7,000. About 25 feet front each by 100 feet deep on lot about 200 feet deep to alley.
Stores, H. S. Heyman, Chester, S. C.
No. 636—Several houses, 6 to 14 rooms, and one store on corner, lot about 22x468, on Gadsden and Walnut streets, Chester, bringing a rent of about \$85 per month; electric lights city water, barn, flower garden and other improvements. Adjacent to the Southern Railway, passenger and freight depots, joining the Carolina & Northwestern shops and Springstein Mill property. Good location for manufacturing purposes, dwellings, or stores to rent. Long established general merchandise business. This is the place to plant your capital for safe investment. Will also sell stock of general merchandise, amounting to about \$4,000.
Several houses and store, H. S. Heyman, Chester, S. C.
No. 671—House and lots on Academy and Pine streets, Chester; No. 1 fronts 147 feet on Academy street by 290 feet deep on Pine street; No. 2 fronts 122 on Pine street by 295 feet deep; both containing 18-10 acres, known as the McLure place.
House and vacant lots, D. Cardwell, Jr., Columbia, S. C.
FARMS.
No. 12—600 acres at Lewis Turn Out, school and church, 400 cultivated, 150 in timber, black soil, level, 6-room dwelling, large barn, fine pasture, 4 settlements, 4 wells, 2 streams, near railroad.
Farm, R. J. Huey, Newport, S. C.

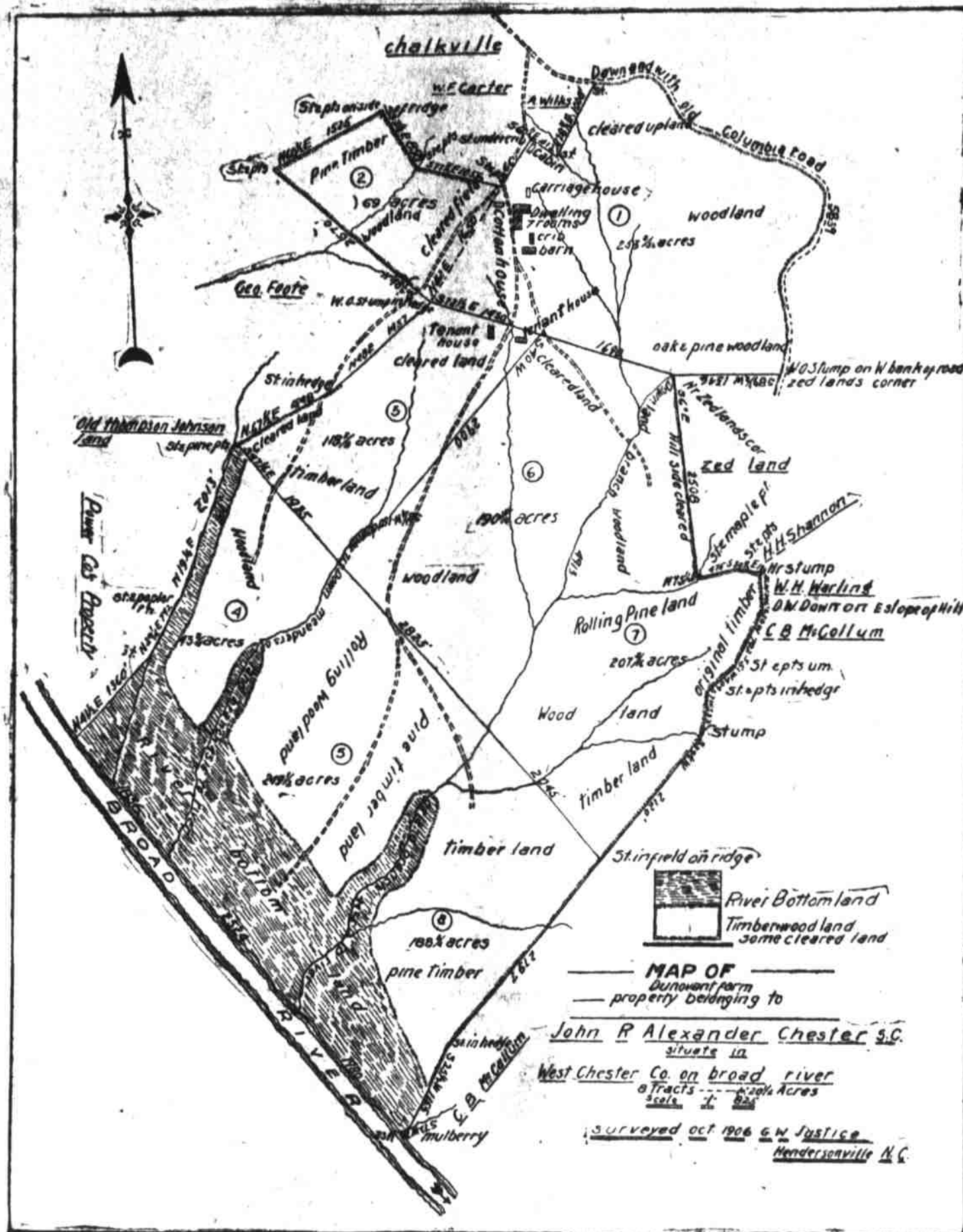

No. 391—314 1-2 acres 2 miles north of Fort Lawn, church and school, public road, 150 cultivated, 50 timber, sandy soil, orchard, rolling, 2-story 7-room dwelling, barn for 3 head, 100-acre wire pasture, 6 settlements, cotton house, crib, smoke house, 2 wells, 4 springs and branch. Would exchange for a farm near Rock Hill.
Farm, D. W. Allison, Catawba, S. C.
No. 543—568 acres, 5 miles Catawba Falls, Bascomville and Fort Lawn, churches and school 1 to 2 miles, 200 acres in cultivation, 725 acres timber, mulatto, black and sandy soil, small orchard, undulating and level, 50 acres waste land, 6-room dwelling, 2 barns, 4 and 8 stalls, 100-acre pasture, 3 tenant houses, 3 3-room houses, cotton houses and cribs. Country remarkably healthy, high elevation, 5 miles from the great electric power plant at Catawba Falls, Rocky and Heaver Dam Creeks; some good bottom land; wells and springs; \$800 income.
Farm, Mrs. Jno. O. Hardin, Richburg, S. C.
No. 632—955 acres 21-2 miles Fort Lawn, church and school, 350 cultivated, 300 timber, grey soil, orchard, level and rolling, 6-room house, barn, 11 tenant houses, creek, etc.
McMullen place, J. B. Daniel, Fort Lawn, S. C.
No. 670—284 acres 6 miles of Cornwells and Blackstocks, church and school 2 miles, 100 cultivated, 25 timber, sandy mulatto soil, 3-acre orchard, the finest in the county; rolling, 6-room dwelling, barn, 100-acre pasture, 3 settlements, 9 miles south of Chester, 6 miles of it macadam road, creek, spring and good well.
Farm, Mrs. M. M. Miller (Blackstock), S. C.
No. 723—52 acres 1-2 miles of Chester, all cultivated, diversified, 2 settlements, barn; on public road, branch and well.
Farm, J. G. Cousar, Chester, S. C.
No. 762—150 acres 3 miles of Fort Lawn; church 2 miles, school 2-4 miles, 100 timber, oak, hickory, pine, diversified, nearly all original timber of the finest kind; creek and branch.
Farm, A. W. McWatters, Fort Lawn, S. C.
No. 818—100 acres 5 miles Leeds, church and school 2 miles, 30 cultivated, 25 timber, sandy soil, rolling, tenant house and barn, spring and branches.
Farm, J. Q. Wilkes, Baton Rouge, S. C.
No. 819—67 acres 4 miles Leeds, church and school 2 miles, 25 cultivated, 15 timber, sandy and black-jack soil, rolling, good bottoms.
Farm, J. Q. Wilkes, Baton Rouge, S. C.

The Steinkuhler Property

Lying near the depots of the Southern and C. & N-W. Railroads, has been cut into 27 LOTS as shown by the map below.

These lots will be sold to the highest bidder on easy terms. 1-3 cash, balance in one or two years from date of sale with interest at 6 per cent. per annum on deferred payments. The seller furnishes deeds and the purchaser pays for bond and mortgage. All the lots put up will be sold for what they will bring without limit. This is very desirable property for homes for working people, as it is only a short distance from the business part of the City. Buy some of this property for homes or speculation as it is bound to increase as the city grows. Take the map, go and examine these lots so you will be ready to buy when the numbers are called by the auctioneer.

Now Stop, Read and Think For Yourself.

Don't depend on the other fellow to advise you what to bid on any of this property, because he expects to buy some of it himself and is not in a position to give you an unprejudiced opinion. Look around you and see how the

Value of all Real Estate Has Advanced by Leaps and Bounds.

With the population of Chester and the County increasing daily, the Electric Power being developed on both sides and the great Rail Road advantages, all Real Estate is bound to become more valuable, and you will not have an opportunity like this, every day in the year, to buy property at your own figures. Don't stand back and expect to buy any of this property at the same price after this sale is over, it will cost you more, and the other man makes the profit. Look over the list carefully and select the piece of property you want and be ready to bid on it when offered by the Auctioneer. We reserve the right to sell any of the property at private sale before the Auction.

J. Edgar Poag, Broker, - - - - - Rock Hill, S. C.

"Cuts The Earth to Suit Your Taste."