

# Louisburg

**THEATRE**  
 Night Shows: 7:15 and 9:00  
 15c and 30c  
 Matinees: 3:30 Daily  
 10c and 25c  
 Saturdays Continuous: 2 - 11  
 10c and 25c until 6 o'clock

HAVE YOU GOT YOUR MOVIE  
 QUIZ BOOKLET YET?

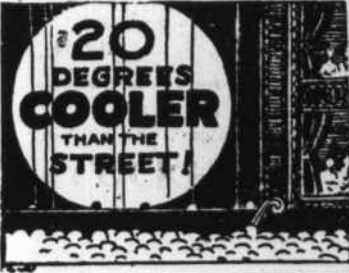

**LAST TIMES TODAY**  
 FRIDAY, SEPT. 16th  
 Martha Raye - Bob Burns  
 Dorothy Lamour

## "Tropic Holiday"

**SATURDAY, SEPT. 17**  
 Double Feature Day  
 Hopalong Cassidy's Latest  
 Adventure

**WILLIAM BOYD**  
 — In —  
**"Pride of The West"**

and  
**JACK HOLT**  
 — In —

## "Reformation"

Chapter No. 8  
**"THE FIGHTING DEVIL DOGS"**

**SUNDAY, SEPT. 18**

Sunday Shows  
 3:30 and 9:00

Don Ameche - Arleen Whelan  
 — In —

## "GATEWAY"

A Movie QUIZ Picture

**MONDAY, SEPT. 19**

Ruby Keeler - James Ellison  
 Anne Shirley - Fay Bainter  
 — In —

## "Mother Carey's Chickens"

From the Famous Novel  
 A Movie QUIZ Picture

**TUESDAY, SEPT. 20**

Robt. Young - Lew Ayres  
 Rita Johnson  
 — In —

## "Rich Man Poor Girl"

Another Movie QUIZ Picture

**WEDNESDAY, SEPT. 21**

Stan Laurel - Oliver Hardy  
 Patsy Kelly  
 — In —

## "BLOCKHEADS"

One of the \$250,000 Movie  
 QUIZ Pictures

**THURSDAY and FRIDAY  
 SEPTEMBER 22-23**

By Far the Best Bing Crosby  
 Picture in Years.

Bing Crosby - Fred McMurray  
 — In —

## "SING YOU SINNERS"

You'll be crazy about this new kid  
 DONALD O'CONNOR.

**COMING NEXT WEEK**

Janet Gaynor in "3 LOVES  
 HAS NANCY."

"Sonja Henie in "MY LUCKY  
 STAR."

**COMING**

Oct. 6-7—Astaire and Rogers  
 in "CAREFREE."

Oct. 9-10 — "ALEXANDER'S  
 RAGTIME BAND."

# TONKEL'S DEPT. STORE A SPECIAL PURCHASING SALE PROMOTION

WILL START NEXT FRIDAY  
**SEPT. 23RD**

LASTING ONE WEEK ONLY

This sale was made possible because we bought direct from the Manufacturers and Mills at the lowest prices in the entire history of our buying power.

Watch for our big four-page circular where you will see the prices slashed to the very lowest points.

**BIG SIZE TURKISH TOWELS**  
 Special Purchase Price  
**5¢**

**MEN'S FALL RIBBED UNION SUITS**  
 Special Purchase Price  
**49¢**

**DOUBLE BED SIZE SINGLE BLANKET**  
 Limited Quantity  
 Special Purchase Price  
**39¢**

**MEN'S WORK SOCKS**  
 Special Purchase Price  
**5¢**

**DRUID LL SHEETING**  
 Special for This Sale Only  
**5¢**

Be sure to attend this Special Purchase Sale as quantities are limited and these prices will only prevail for a period of one week.

# TONKEL'S DEPARTMENT STORE, INC.

"SOMETHING ALWAYS NEW"  
**"Louisburg's Shopping Center"**  
 Sell Your Cotton and Tobacco in Louisburg

Louisburg's Biggest and Best Store

WE  
WONT  
BE  
UNDER-  
SOLD

# FOX'S

DEPARTMENT STORE

A BIG  
STORE  
WITH  
BIG  
Values

**FALL IS A SEASON OF GLAMOUR**



Your **WINTER COAT** is the Basis of the New Costume

At **FOX'S**  
**\$2.98 to \$39.50**  
**DRESSES**  
 Are Most Important

Expensive looking styles for little money. Dresses that you'll wear now and later this winter under your coat. The colors will give you a new lift in the new season.

PRICED FROM  
**\$1.98 to \$19.50**

**FOX'S**  
 IT'S A GAY  
**HAT Season**

With the most becoming styles you've ever had the luck to see. Rich luscious colors and real new shapes.

**98c up**

**BLOUSES**  
 ARE DAINTY OR MANISH

And so lovely, soft rich fabrics, exquisite fashion touches and an unbelievable variety of styles.

**69c up**

**SLIPS Give Your**  
 COSTUME STYLE AND FIT

These slips are designed to fit and made to wear. Luxury fabrics soothing to the skin. Styles most alluring.

**\$1.00**

**Archer HOSIERY**

Thousands of women are boosters for this grand stocking, they know it wears and wears. See the New Fall Shades.

**98c**

**New Fall SHOES**  
 THE TALK OF THE TOWN

Stunning styles, soft leather uppers, flexible leather soles, black, brown or wine, suede or calf. New Chinaboy heels also platform and wedges.

**\$1.98 up**

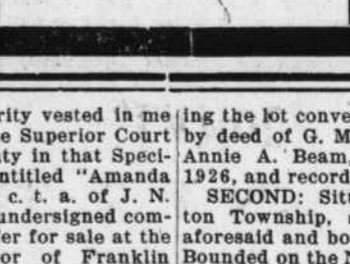

STYLES ARE NEW  
**Men's HATS**

There's more style in these hats than you've ever expected at anywhere near the price. Every New Fall Shade too.

**98c**  
**Men's Fur Felt Hats \$1.98**

FALL'S NEW PATTERNS  
**Men's SHIRTS**

Tailored by Shirt makers who specialize in Higher Price Shirts only. Exceptional fabrics and the newest patterns.

**98c**  
 And as low as **48c**

THE ENVY OF THE CLASS  
**Girl's DRESSES**

They loves these new dresses in Jitter Bug, Dirndl and Swedish styles in thrilling new prints. FROM

**59c up**

PART WOOL  
**BLANKETS**

Warm and Comfy and so beautiful, large enough for any bed.

**\$1.98**

**WEDGIES**  
 THE NEW FALL HIT

FOX'S was the first to bring this New Style to town, and you know it. Here are new styles that will send you rushing in.

**\$1.98 up**

**TO PURCHASE BUTTER**  
 The Federal Surplus Commodities Corporation has been authorized to purchase 10,000,000 lbs. of butter from the Dairy Products Marketing Association, producer cooperative organization, for distribution through State relief agencies.

If you don't intend doing anything about it, worry is silly. If you do intend to do something, worry isn't necessary.

**ADMINISTRATRIX NOTICE**  
 Having qualified as Administratrix of the estate of Thomas Cheatham Alston, deceased, late of Franklin County, North Carolina, this is to notify all persons having claims against the estate of said deceased to exhibit them to the undersigned on or before the 16th day of Sept., 1938, or this notice will be pleaded in bar of their recovery. All persons indebted to said estate will please make immediate payment. This 15 day of Sept., 1938.

MRS. T. C. ALSTON,  
 Admrx.  
 9-16-6t.

power and authority vested in me by an order of the Superior Court of Franklin County in that Special Proceedings entitled "Amanda P. Alston Adm. c. t. a. of J. N. Perry, dec'd, the undersigned commissioner will offer for sale at the Court House door of Franklin County, in Louisburg, N. C. for cash at or about the hour of noon, on

**MONDAY, OCTOBER 17TH, 1938,** the following described tracts or parcels of land, situate in the County of Franklin, State of North Carolina:

**FIRST:** Situate in the Town of Franklinton, county and state aforesaid, and beginning at a stake on the South side of the Louisburg road in said Town 24 feet West of where the corner of the Howard Store Building formerly stood; thence West along said Louisburg road 116 feet to Howard's corner on the Tan yard lane; thence South along the Tan yard Lane 85 feet to a stake, corner of the Howard Home Lot; thence along the line of said Home lot 123 feet to a stake on the edge of a big ditch; thence about North in a straight line to the beginning and being a part of the lands conveyed to G. M. Beam by R. B. White, Trustee; and being

the lot conveyed to J. N. Perry by deed of G. M. Beam and wife, Annie A. Beam, dated May 6th, 1926, and recorded May 6th, 1926.

**SECOND:** Situate in Franklinton Township, state and county aforesaid and bounded as follows: Bounded on the North by the lands of C. N. Sherrod; on the East by the lands of C. N. Sherrod on the South by the lands of —, —, Sherrod and on the West by the lands of the estate of J. N. Perry, containing 86 acres, more or less and being the tract of land conveyed to J. N. Perry deceased by deed of R. B. White, date November 29th, 1899, recorded in Book 114 page 280, Registry of Franklin County, N. C.

**THIRD:** A one-eighth undivided interest in and to that certain lot or parcel of land situate on Main Street in the town of Franklinton, state and county aforesaid, beginning at an iron stake D. F. McKinne's corner; thence 50 feet N. to an iron stake; thence E 61 feet to an iron stake; thence S 50 feet to an iron stake; thence — 61 feet to the point of beginning, it being the lot or parcel of land conveyed to J. N. Perry et al by deed of D. F. McKinne and wife recorded in Book 229 page 600 Registry of Franklin County,

N. C.

**FOURTH:** Situate in the county and state aforesaid, adjoining the lands of Bartlett Perry, J. N. Perry and others and described as follows: Beginning in Simms Bridge Road, Bartlett Perry's corner, 15 links N 71d W from an iron stake inside of road; thence along said Perry's line S 71d E 19.75 chains to an iron stake, J. N. Perry's corner; thence along said J. N. Perry's line N 29d E 13.25 chains to a stake; thence N 20 1/2 d E 21.75 chains to Simms Bridge road 65 links south of a small oak; thence along said road S 47 1/2 d W 2 chains S 35d W 3.27 chains, S 39d W 5.53 chains, S 55 1-4d W 24.82 chains, S 59d W 6 chains to the beginning, containing 31-1-5 acres, more or less, and being that part of the Fuller lands lying on the East side of Simms Bridge Road and being the tract of land conveyed to Jacob N. Perry by deed of Haywood Perry, dated April 10th, 1907, and recorded April 15th, 1907.

This the 15th day of September, 1938.  
 J. E. MALONE,  
 Commissioner.  
 For any information regarding this land call on White & Malone, Attys.  
 9-16-4t.