

WATCH CHARLOTTE GROW 200,000 by 1930

THEY OWN THEIR HOMES IN CHARLOTTE

Sixty (60) per cent. of the dwellings in Charlotte, excepting only such as are occupied by the very small tenement class, are occupied by the owners.

No other city in the United States, with approximately the same population as Charlotte, has as large a number of home owners.

Charlotte has four Building and Loan Associations, with seventy-six thousand shares, owned by six thousand people.

Charlotte's Building and Loan Associations' disbursements

to six thousand shareholders for 1923 were \$2,300,000.00
Assets of the four associations (1923) 3,500,000.00

One of the four associations is forty-one, and the other is forty-three years old; and not one of the four ever sustained a loss from loans.

2 SERVICE STATIONS

Two plants of the Bierman Engraving Company render prompt and efficient service to the printers and engraving buyers of the Carolinas.

This map shows clearly the location of these service stations with respect to the principal cities and towns. We have available Highway Maps of both North and South Carolina, that with slight alterations will show the location of your service stations.

Our Art Department will help you prepare it. Come in while at the show and let's talk it over. The map in the corner shows our Charlotte location.

BIERMAN ENGRAVING CO.

DESIGNERS
ILLUSTRATORS
RETOUCHERS
SHADING TINTS

ZINC ETCHINGS
EMPOSSING PRES
HALFTONES
COLOR PLATES

COR. DAVIS & SYCAMORE STS. GREENSBORO, N. C.
COR. CHURCH & FOURTH STS. CHARLOTTE, N. C.

WILMOORE LOTS

The Most Available Location in Charlotte for Homes of Moderate Cost



Views Showing Building Development in Wilmore

WILMOORE LOTS

Wilmore property extends from Dilworth on the east to the main line of the Southern Railway on the west, and is within the city limits of Charlotte, and just at the foot of Tryon and Mint Streets.

WILMOORE LOTS

are 50x100 to 200 in size and are offered at a very low price compared with other properties.

They can be bought on easy terms of payment—one-fourth cash, balance in six, twelve, eighteen months, with six per cent. interest, or five per cent. discount if all cash is paid.

OVER 300 LOTS ALREADY SOLD

Many new and attractive homes have been completed recently. Park Avenue lots have doubled in value during the past year. Better invest now—and benefit by the rise in values.

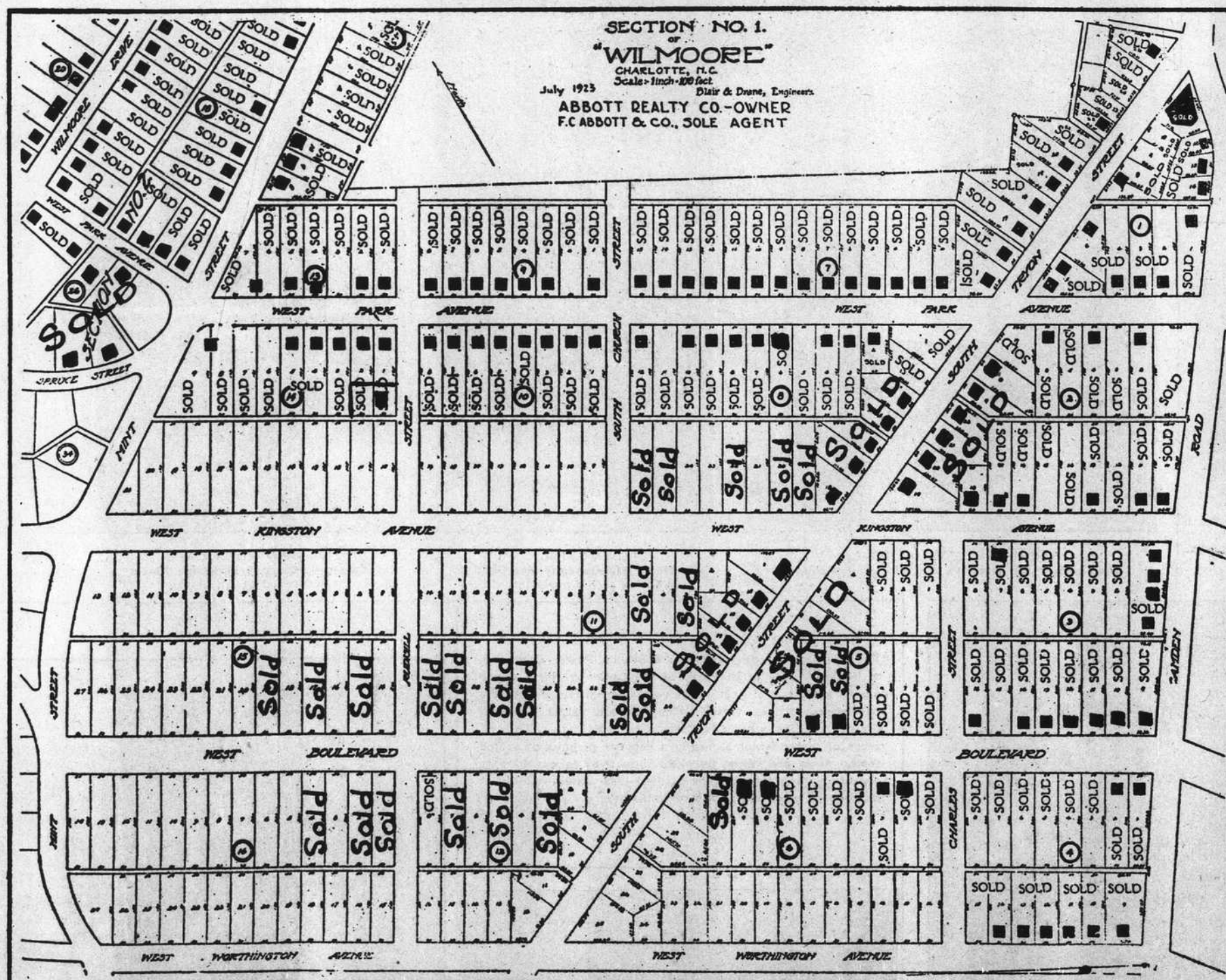

This Map Shows Section One, Located Between Dilworth and Mint Street. The Squares Indicate Homes Already Completed. Others Under Construction.

WILMOORE LOTS

Every lot in Wilmore is well within the city limits. It is the most attractive location for YOUR home to be found in Charlotte.

WILMOORE LOTS

are not only within walking distance of the business section of Charlotte, but are within five minutes walk of the following industrial plants and therefore available for the employees of these companies:

- Charlotte Wagon & Auto Co.
- Bostick Candy Company.
- McClaren Rubber Company.
- Charlotte Pipe & Foundry Co.
- The Elizabeth Mills.
- Southern Cotton Oil Co.
- Parks-Cramer Company.
- Citizens Lumber Company.
- Saco-Lowell Company.
- Doggett Lumber Company.
- Union Warehouse & Storage.
- Charlotte Knitting Mills.
- Robinson Spinning Company.
- Park Manufacturing Company.
- Charlotte Storage.
- Bonded Warehouse Company.
- Atherton Mills.
- Textile Mill Supply Company.
- Carolina Baking Company.
- Southern Carbonic Company.
- Garrison, Hopkins Company.
- Carolina Exposition Company.

All Lots on WestPark Avenue and South Tryon on to Kingston Avenue have been Sold. We now offer fine Lots on West Kingston and West Boulevard at \$1,000 each on terms or cash. We will sell every other Lot at this Price, reserving alternate Lots for increase in value—believing in Charlotte's future

ABBOTT REALTY COMPANY, Owner

F. C. ABBOTT, President

F. C. ABBOTT & CO., Selling Agent

T. M. ABBOTT, Mgr. Real Estate Dept.