

# THE ROWAN RECORD

Published Weekly.

CHINA GROVE, N. C.

## NEWS BRIEFLY TOLD

### A CONDENSED RECORD OF EVENTS OF THE WEEK.

### SEVEN DAYS' NEWS AT A GLANCE

Important Happenings in All Parts of the World Summarized for the Busy Reader.

#### Southern.

Governor O'Neal of Alabama would like the city of Montgomery to afford him better protection from midnight visitations of burglars. The governor has had five visits from burglars, which have occurred within the past few weeks. Altogether, burglars have broken into the executive mansion two times, and have attempted to break in on three other occasions. Some weeks ago several rings were taken from the governor's mansion.

John G. Kerney of Kernersville, N. C., one of the most prominent men in that section of the state, has been shot and probably fatally wounded by a young man named Claude Dickens. Mr. Kerney had gone to his mill plant for some purpose and found several young men drinking and carousing. He intervened when it is alleged, Dickens became insulted, ran into his house, and, picking up a shotgun, emptied the entire load into Mr. Kerney's arm and side at a range of 20 to 30 feet.

When L. J. Waxelbaum returned to his home in Mason, Ga., after an absence of four or five days, he found that his home had been converted into a hotel for burglars. The unbidden guests had evidently been making the most of their sojourn and had taken their time in ransacking the house for valuables. They had taken a mattress from one of the beds and placing it on the floor had apparently rested from their labors long enough to play a few games of cards and consume a goodly portion of Mr. Waxelbaum's supply of "high-beer."

#### General.

If you have been accustomed to going to the postoffice on Sunday and getting your mail, or looking for it at your hotel, take notice: "Henceforth" of the first and second class shall not be open Sundays for the purpose of delivering mail to the general public, but this provision shall not prevent the prompt delivery of special delivery mail." That is the language of the postoffice appropriation bill which has just passed congress.

Half a million people struggled to enter Congress hall in London to gaze on the dead features of Gen. William Booth. There was no disorder. It was not necessary to call for police reserves. Soldiers of the Salvation Army, women as well as men, patrolled the outside and interior of the big building, keeping the vast throng moving, gently making a way for the old, the feeble or the children.

Joseph G. Robin, who is in the Tombs in New York City awaiting sentence on his conviction for grand larceny in connection with the wrecking of the Northern bank, is said to have made another fortune through speculation which he carried on while in prison. While in the Tombs and during the daytime, it is reported, he occupied a room in the criminal courts building, which is equipped with a telephone and typewriter.

Four members of the family of Jefferson Ruhlo, a road worker, were killed by lightning, which struck the tent they were living in near Desota, Mo. Ruhlo, his wife, a 16-year-old daughter and a baby girl were instantly killed. A grown son escaped death, but was stunned and severely burned. The foreclosure of the mortgage on a Montana home was prevented and the savings of a lifetime were restored to Mrs. Katherine McDonald of Butte, when congress passed the Shoshone irrigation claim bill. Mrs. McDonald will receive \$11,000 of the \$42,000 carried in the bill for the relief of about 400 claimants who lost heavily by the failure of a contracting firm, which was erecting the Wyoming irrigation project. President Taft approved the measure in its final form.

The massacres by the Turks have extended to the Serbian frontier. Telegram received from Stentiza on the southern boundary say the Turks attacked the town and butchered several of the inhabitants. News of the massacre caused great excitement in Belgrade, and the newspapers issued special editions containing demands that the Serbian government protest vigorously to the porte. The citizens are loud in their clamor for a declaration of war against Turkey.

J. W. Moyer, an actor, in reaching for his hat, which blew off his head, fell from the rear platform of a train on the New York, New Haven and Hartford railroad near Pelham, N. Y., and was killed.

Thirty skeletons and mummies have been found in the southern part of Mexico. Dr. J. F. Goslin, a Big Rapids dentist, his wife and 4-year-old son were killed and his mother probably fatally injured and his son, Burr, 11 years old, slightly hurt when a freight train crashed into their automobile, near Howard, Mich.

The steamer Pennsylvania was severely shaken by an earthquake during the trip from Panama and while off Manzanillo, on the Mexican coast. The shocked last at least seven seconds.

The gunboat Des Moines was ordered by Acting Secretary of the Navy Winthrop to visit Mexico.

William Sorbet, aged 11, of Abbeville, La., who three years ago accidentally killed a younger brother with a shotgun, killed an older brother with the same weapon when it was accidentally discharged. The family is heart-broken.

### EXCELLENT FOR SWINE

Cowpeas Almost as Good as Clover for Hog Pasture.

Forage Plant Well Adapted to Needs of South and Among Best Crops for Grazing and Sowing—Source of Profit.

Hog raisers should grow cowpeas for hogs are fond of them, and they are almost as good, if not fully as good, as red clover or alfalfa. In fact the cowpea has been described as being to the south what red clover is to the north, or alfalfa to the west—a forage plant well adapted to the needs of the region—and esteemed among the best crops for grazing and sowing.

By judicious selection of varieties, fields ready for use can be had from midsummer until cold weather, and a good part of what is needed for this purpose can be grown as a catch crop without interfering with the regular crops grown on the same ground. This is especially so when they are grown between corn rows, being planted when the corn is laid by and grazed after the corn is gathered. Probably about half of the cowpeas grown in the south are grown and grazed in this way, and are regarded as providing the best possible pasture for hogs. They just can't be beat, and more of them should be raised for the bacon and lard makers.

When cowpeas are pastured by hogs the droppings return nearly all the fertilizing elements of the crop to the soil and benefit the field nearly as much as though the entire crop were plowed under as a green manure. The meat produced is clear profit. The crop does not bear continuous grazing, still it gives abundant food for a month or six weeks, and by arranging a succession of fields good pasture may be provided during several months. More actual feed is produced with less waste per acre when the vines are cut or pulled for soiling, for which cowpeas are a great crop. A bulletin issued by the Mississippi experiment station says that in that state cowpeas for hogs, pasture, without grain, have given better results than any other crop. In one test the crop was grown on their hill land, where one acre of cowpeas produced 350 pounds of pork. In another test on rich valley land one acre of cowpeas produced 483 pounds of pork. The hogs were turned into the field when the peas were about ripe. Cowpeas will do well in any state south, and they can be made a source of great wealth to the south by feeding them to hogs if southern farmers will catch on and plant more hogs and cowpeas.

Cost of Brood Sow.

It costs about \$10 to keep a breeding sow a year. If she gives you two litters of pigs each year, there should be a clear profit of at least \$20 from her, and you have your sow left in the bargain.

### GENERAL FARM NOTES

Be sure there are no lice on the hogs.

Keep the calves in clean quarters out of the hot sun. Do not put the colts in a pasture fenced by barbed wire. A bottle of vasoline is handy to have around at milking time. Scours in pigs is an indication of indigestion in the mother. It may be wise to protect the colts from the flies during the day. If a cow falls off in milk now it will be hard to bring back the flow. Cows can't be blamed for trying the fences when pasture gets short. Wheat middlings is one of the best feeds for young and growing pigs. Be sure the mares and colts in pasture have shelter from the hot sun. Only a little buttermilk not worked out will mean rancid butter in a short time. Three hundred dollars in a silo beats having that much money in the bank. Whole oats placed on a dry, raised platform are a most profitable feed for young pigs.

The man with cows coming fresh in the fall has cream to sell when the price is at a premium.

Fruit of every kind should be thoroughly cooled before being packed for the market.

Ducks as a rule are hardy. They do not have the gaps. The weakest part of a duck is its legs. Chicks on a hard board floor soon develop leg troubles. Sprinkle fine earth or sand over it.

Ewes that are broad and long will make good brood mothers, and produce vigorous offspring.

Orchard men of noted fruit sections of the country practice thinning as faithfully as they do the spraying and pruning of trees.

Pigs that have been properly grown up to five months with big strong frames, can be rounded up quickly for market with a ration consisting largely of corn.

In selecting a ram always pick one that stands square on his legs and shows courage and masculinity. A slow, poky animal will prove a disappointment.

When pure-bred swine are kept for breeding purposes they should be given every opportunity for bone and muscle development, rather than the production of fat.

When disposing of some of the old stock pick out the poor layers. They are "hard to get rid of" for roasting purposes, and you cannot afford to part with the money-makers.

Fowls are obliged to throw off much of the waste of the body through the lungs. They do not sweat in the sense that do other animals, but instead breathe several times faster than sweating animals when heated. To keep in good health a hen requires nearly seven times the amount of fresh air in proportion to its size as does a horse.

Necessity for Fresh Air.

Fowls are obliged to throw off much of the waste of the body through the lungs. They do not sweat in the sense that do other animals, but instead breathe several times faster than sweating animals when heated. To keep in good health a hen requires nearly seven times the amount of fresh air in proportion to its size as does a horse.

### MILK HOUSE FREQUENTLY IS OVERLOOKED



Exterior View of Milk House.

(By J. E. BRIDGMAN.) While it sounds strange, it is true that many farmers who are making the larger portion of their yearly income from milk have no milk house. They have a calf shed, implement house, barn, corn crib, granary, etc., all built for the purpose of caring for and protecting the various products or tools used on the farm, but they have never thought it necessary to build a milk house. Many model housekeepers are compelled to keep milk in unsanitary rooms, such as some outbuilding, the cellar, kitchen, or other general purpose room for the reason that there is no milk house.

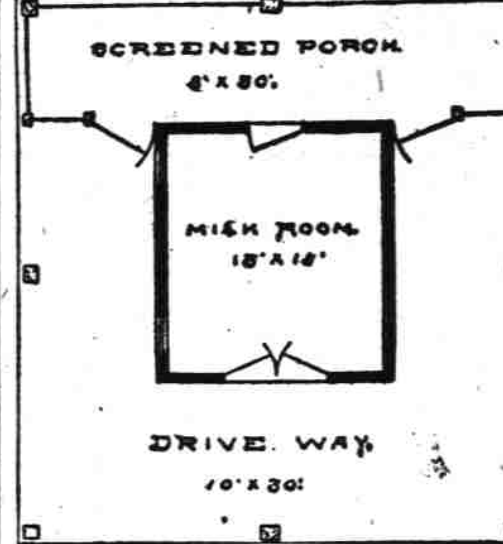

Floor Plan of Milk House.

Milk should be kept in a room used for no other purpose, and in some states an attempt has been made to pass laws governing the keeping of milk on the farm, that is, milk that is sold or used for any purpose except on the farm. The small milk house here shown will certainly cost several dollars, but is it not worth it? The structure should, of course, be built of cement, but build it of brick, stone, or even wood if you cannot build it of cement. The idea is simply a suggestion. The screened-in porch for a workroom would come in mighty handy along about fly time and the driveway certainly would be used. The side porches are for keeping out the sun, but they would be utilized for storing number of cows kept, but a room of the size given on the floor plan will be found ample for quite a number of cows.

### DIVERSIFY IN FARMING

#### One-Crop System Fails to Bring Permanent Prosperity.

Not Enough Attention Given to System of Rotation by Average Farmer—Raise More Live Stock to Increase Profit.

That a one-crop system has failed to bring permanent prosperity to any considerable area is verified many times in the history of agriculture. However, much has been gained by devoting certain limited areas to a one-crop production. We believe the above fact to be true and that enough attention is not given by the average farmer to a system of rotation which is adapted to the soil and climatic conditions with which he must deal, says the Gem State Rural Journal. The fact that one locality will produce fruit successfully has led men to squander their means in attempting to grow commercial orchards where only failure can possibly be the reward. A crop rotation should contain only such plants and products as are adapted to the soil and climatic conditions, and have a commercial value either directly or indirectly. However, it is not enough to know that a crop will grow well and produce abundantly. This is the chief difficulty now where there is a superabundance of alfalfa produced with not enough foresight given to the disposition of the crop after it is grown and made into hay. Too many trust to an uncertain market for the raw product, and give too little attention to the conversion of the raw material into the finished article. Every rational system of diversified farming must embrace the growing of animals and the manufacture of animal products either on the farm or in the large central plants. To grow more animals successfully a wider range of farm crops is necessary. More grain and cultivated crops should be grown to combine with the staple hay and pasture crops to get the best results, and reap the largest returns for labor and capital invested. Many of the old alfalfa meadows should be plowed up and put to growing other crops for a term of years; and the new alfalfa should be sown on lands which would be much benefited by seeding to alfalfa. Oats and barley produce abundantly and wheat as well, after the alfalfa. All kinds of hoed crops do well, including the potato and root crops. In growing a young orchard it does not hurt to plant some hoed crop between the trees, such as corn, potatoes or beans. This is putting into practice the theory of rotation. As the trees grow into bearing the spaces between them can be seeded to clover for a time to advantage, thus carrying still further the idea of growing a variety of crops on the land. But above all things see to it that more live stock is produced to consume the surplus and the waste material which is found on every farm, and which should contribute to the net income of that farm.

Worth of a Hen.

France classes the worth of a hen more for the production of meat and eggs than she does for the fine feathers or standard looks. Some years ago the poultrymen aimed for show records, and while they do not doubt gained their point, they at the same time ruined the stamina and thrift of the hen for commercial purposes. Today it is different. Utility has taken a front seat and all breeds are bred up to conform with the ideas of the market poultryman.

### SET PLANTS IN MIDSUMMER

#### Henry Jerolaman, Strawberry King, Tells of Methods Employed to Get 8,000 Quarts to Acre.

In the famous strawberry section about Hilton, N. J., many growers set out new beds the last of July or early August, says the Agriculturist. Beds thus set are fruited the following year. Immediately after the crop is harvested, which usually ends about the first week in July, the strawberry mulch is raked off and the soil worked with a hoe or rake. Runners for new plants are put out and layered in the usual way. As soon as they are large enough they are set out in the new beds. The strawberry king, Henry Jerolaman, says: "The strawberry is a vigorous feeder, and should have plenty of plant food when it needs it most. I use well-rotted horse and cow manure mixed. Spade or plow it under and work the soil until it is well distributed." "After the plants are started put some fine, well-rotted manure or compost around each plant. This may seem troublesome, but it pays. It not only fertilizes the plant, but protects it during the winter. My rows are two feet ten inches apart, and the plants are every 15 inches in the row. With this method I have no trouble in getting six to eight thousand quarts an acre."

If the plants are set during a hot, dry spell, they should be watered. Mr. Jerolaman always puts a pint of rain water to each plant. After dropping the roots in the hole made with the hand, the water is poured in, and the dirt drawn around the plant. Each plant should be shaded in hot weather during the middle of the day after it is set, at least two days. Strawberry baskets are turned upside down over each plant. If plants are very large, old peach baskets or anything of that sort can be used.

### OPERATION OF A GAS ENGINE

#### Plan and Illustration for Stopping Pump When Tank is Full—Simple and Inexpensive.

J. W. Moeller sends the Iowa Homestead an illustration and plan for stopping a jump spark gas engine pumping water when the tank is full. Take some insulated copper wire,

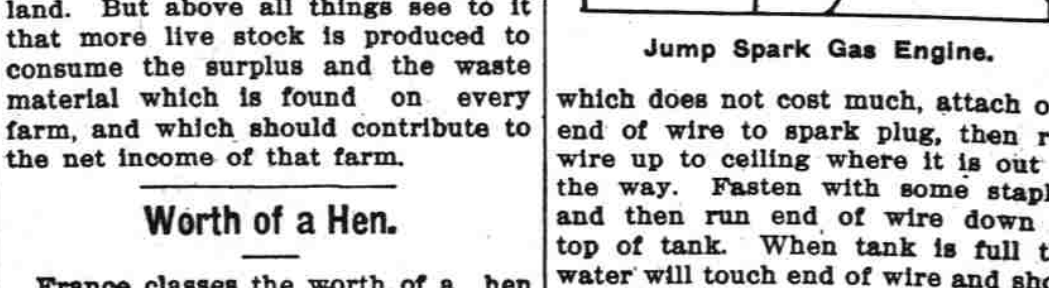

Jump Spark Gas Engine.

which does not cost much, attach one end of wire to spark plug, then run wire up to ceiling where it is out of the way. Fasten with some staples and then run end of wire down to top of tank. When tank is full the water will touch end of wire and short circuit the current which stops the engine. By this plan the engine may be started and left for an indefinite length of time, for when the tank is full the engine will stop.

#### Feed for Lambs.

Tobacco stems chopped fine or tobacco sweepings mixed with salt are good to feed young lambs, particularly if they are affected with worms.

#### Pure Bred Cows.

Cows that give 250 pounds of butterfat, or 3,000 pounds of three per cent. milk, are not accidentally bred or purchased of cow merchants with their pedigrees ascertained. They must be bred from cows with high record milk ancestry behind them and sires from the same kind of ancestry. Here again comes in this breeding direct line from one breed, as the hen fanciers assert, the same strain of an influence or family of that breed.

#### Drain All Low Spots.

Why not drain all those low spots after the crops have been cared for and add to the acreage?

### SATISFACTORY FIRE-PROOF SMOKE HOUSE



Diagram of Smoke House.

on a ledge or projection from the walls on each side. These pieces of plank have hooks driven in on both edges far enough apart to receive the hams, so that a row may be hung on each side. When full, each is pushed along to one side and another filled, and so on till all are in their places. The ventilators above are then opened, and smoke is started on the heap of ashes below. For this purpose, cobs are used, or unseasoned maple, or body hickory. The smoking should be slow. By the time the smoke has passed up through the opening in the arch, it has become cold, and cannot heat the hams. Ten or twelve days will usually be enough for the completion of the operation, when the ventilators at the end and in the chimney are closed about. The hams being now kept perfectly dark and thoroughly excluded from the air outside, they will keep in good condition; flies will do no injury through the summer with a small fire started once a month, and with the upper ventilator partly open at the time. This obviates the common and troublesome task of encasing the hams in muslin, whitewashing them, or packing them in oats or ashes.

It is obvious that the apartment used as a store room may be omitted, and the smoke house built alone. The smoke room in this building is six by ten feet in the clear, which is larger than most families require. The great points here attained are perfect protection from cool smoke, ready access, and handling, and an easy mode of keeping the hams through the summer in perfect condition. Double brick, hollow walls might be even better than stone. The rafters should be ten inches wide, strongly lathed, plastered, and filled with sawdust to keep the room cool.

In response to a query as to a simple smoke house for family use and the best methods of smoking hams and bacon in small quantities the following reply:

A fire-proof smoke house, and store-room combined that has given excellent satisfaction was built as follows:

The building is divided into two sections, that facing the dwelling and situated at the right end in the diagram being enclosed in stone walls and closed with dark shutters when desired, answers a useful purpose for keeping fruit, fresh meat and provisions generally.

The left-hand half of the building is occupied with the smoke house. The diagram shows the position of the different parts. The ash pit, surrounded by stone walls and a layer of stone beneath, laid in water-lime mortar, and securely coated with the same, keeps the ashes dry, and no water can enter. The ash pit is entered by an iron door, shown both in the view and section. Over it is a brick arch, containing several holes the size of a half brick, through which the smoke passes into the smoke apartment above, which is entered by the outside door on the left end of the building, by the assistance of a stepladder. This smoke house is six by ten feet in the clear. The ventilating window at the end, and the ventilating chimney at the top, are both opened when the hams are smoking, and closed when the operation is completed. The top of the arch forms the floor of the smoke room.

A large number of hams may be placed in this room by the following arrangement: Pieces of hardwood plank, eight inches wide and long enough to reach across the room, rest

fine working order for either wheat or corn.

#### One Good Mutton Breed Best.

Mutton sheep should never be of mixed breeds on one farm. Get one good mutton breed, stick to it and develop the highest notch possible. A lot of mixed lambs never bring the highest price on the market. It is those of one breed, uniform in size, shape and condition that get the big money.

#### Cane Hard on the Soil.

Many farmers avoid planting cane because they think it is hard on the ground. In some respects this, as the writer has seen, is true. All sorgho crops have the ability to use the water content of the soil down closer than most plants do. The effects are plainest in the following season if the cane is followed by a spring crop. However, sowing some legume crop in early summer after harvesting a crop of cane would bring the soil into



FOR Luncheon—or picnic sandwiches, nothing equals Libby's Veal Loaf



More often it is the man who gets justice that kicks.

A woman seldom hits anything she aims at, especially if she throws herself at a man's head.

A great majority of summer illnesses are due to Malaria in suppressed form. Lassitude and headaches are but two symptoms. OXIDINE eradicates the Malaria germ and tones up the entire system.

The old hat on a woman's head hasn't the slightest resemblance to the new one she has on her mind.

For SUMMER HEADACHES Hicks' CAPUDINE is the best remedy—no matter what causes them—whether from the heat, sitting in draughts, feverish condition, etc. 10c., 25c. and 50c. per bottle at medicine stores.

And many a girl who starts out with the intention of making a name for herself winds up by turning the job over to some man.

If your appetite is not what it should be perhaps Malaria is developing. It affects the whole system. OXIDINE will clear away the germs that cause Malaria and generally improve your condition.

The Long and Short of It. "Struggling young lawyers mix things up, don't they?" "In what way?" "They seldom have a brief career when they run short."

#### Cost of Living Reduced.

The King Fruit Preserving Powder will keep perfectly fresh all kinds of fruit, apples, peaches, pears, berries, plums, tomatoes, corn, okra, cider, wine, etc. No air-tight jars needed. Used more than 25 years from New York to Florida. A small package puts up 50 pounds of fruit and taste is just as when gathered. Saves money, time and labor.

Barber Shops in China. Since the Chinese revolution a great many Chinese have had their cues cut off, and this has led to the opening of a large number of barber shops throughout the far east where Chinese are located, says an exchange.

Several progressive business men of Singapore, anticipating this, imported a large number of American barber chairs, and they are now unable to get supplies quickly enough. It has also been learned that the Chinese insist on having American hair clippers, and refuse all other makes offered them.

It would seem that American manufacturers of barbers' supplies should experience a large increase in their Oriental trade.

STERN NECESSITY.



He—Isn't your bathing suit rather loud? She—It has to be loud. I'm trying to mash a deaf old millionaire.

### A Large Package Of Enjoyment—Post Toasties

Served with cream, milk or fruit—fresh or cooked.

Crisp, golden-brown bits of white corn—delicious and wholesome—

A flavour that appeals to young and old.

"The Memory Lingers" Sold by Grocers.

Postum Cereal Company, Limited, Battle Creek, Mich.