

Home Hints

By Ruth Current
State Home Demonstration Agent
Wise Waste—1949 Resolution:
 To throw away sometimes is thrifter than to save, household management specialists say. They explain that some articles, likely to accumulate around the house, are accident hazards which should be discarded promptly.

Any chipped or cracked glass ware—whether tumbler, canning jar, cooking or serving dish—should be retired from use to prevent cuts as well as possible waste of food. Chipped enamelware also should go out of kitchen service because it may leave tiny glasslike particles in food prepared or cooked in it. Once china or pottery is cracked or chipped, it cannot be kept sanitary by ordinary dish washing. A cracked cup, therefore, is a health hazard as well as an accident hazard.

Tipsy pots and pans have caused many a serious burn. Cooking utensils should stand steady on the stove.

Home medicine cabinets are likely to fill up. Old pills, prescriptions and remedies are a nuisance and are dangerous to have around. They should never be saved for future use except on specific instructions from the physician. Some drugs deteriorate with age.

Other items which may wisely go out are toys with sharp points or edges or any loose parts which a child can get into his mouth. Toys also have proved dangerous for young children. If they cannot be fixed for safety, it pays to throw it away.

Finally, be sure not to throw items on trash heap or into open containers where children can find them.

Poison Aids Thieves
 SIMLA, India (AP)—Thieves in the East Punjab Railway were operating on a new technique before they were found out and 14 of them arrested. Dressed in military uniform, they used to offer poisoned food to traveling military officers. After the victims became unconscious, the thieves stole their belongings.

PAUL Hobby-craft S
 613 BROAD ST. BEAUFORT
Made To Order CABINETS — SIGNS
Low Bros. Paints

Farmer Grows Pork By Acre

COLLEGE STATION, Raleigh — Pork is generally measured in terms of pounds or number of hogs, but a Tyrrell county farmer, R. L. Spruill of Columbia, Route 1, says he grows it "by the acre."

His method, according to County Agent H. H. Harris of the State College Extension service, is to let hogs do his corn harvesting, a job at which they seem to be pretty efficient.

Mr. Spruill planted three acres of corn in one field last spring, and by August he estimated the crop would yield 66 bushels per acre. He decided to run a hogging-off demonstration.

On August 19, a total of 27 pigs weighing 2,862 pounds were turned on the field. For 67 days they went about eating all the corn they wanted.

By October 25, the pigs had added 2,688 pounds and weighed a total of 5,550 pounds. Thus, Mr. Spruill figures he produced an average of 896 pounds of pork per acre.

At \$1.25 a bushel, the estimated corn yield from the three acres would have brought \$247.50. Mr. Spruill spent \$64.80 for 1200 pounds of supplement and \$3 for 30 pounds of mineral to feed the pigs. In other words, the corn, supplement and mineral cost \$315.30.

The hogs sold for 25.5 cents per pound. The 2,688 pounds added during the demonstration thus brought a return of \$685.44, and the net profit from the hogging-off was \$370.14.

Two other facts were observed. First, Mr. Spruill made a profit of \$5.52 per day just by watering and caring for the pigs. Second, considering the hogs as harvesters and marketers of corn, Mr. Spruill was able to realize a return of \$125.05 per acre above feed cost, in addition to saving the expense of harvesting the corn.

HARLOWE

Jan. 11 — Mesdames Harry Davis, Emma Oglesby, Roy Mason and George W. Ball and Miss Lena B. Hill spent Wednesday with Mrs. Carl Whitehead at Crab Point.

Mrs. L. C. Blanchard, of near New Bern, spent Thursday afternoon with Mrs. Ashby B. Morton. Walter Taylor, of Wilmington, spent Tuesday here with relatives. Mr. and Mrs. Ralph G. Temple were in Beaufort Thursday afternoon on business.

Philip Taylor spent Friday in New Bern and attended a meeting at the County agent's office. Mrs. William Valalias, of New

LOCATION OF FATAL HOME ACCIDENTS

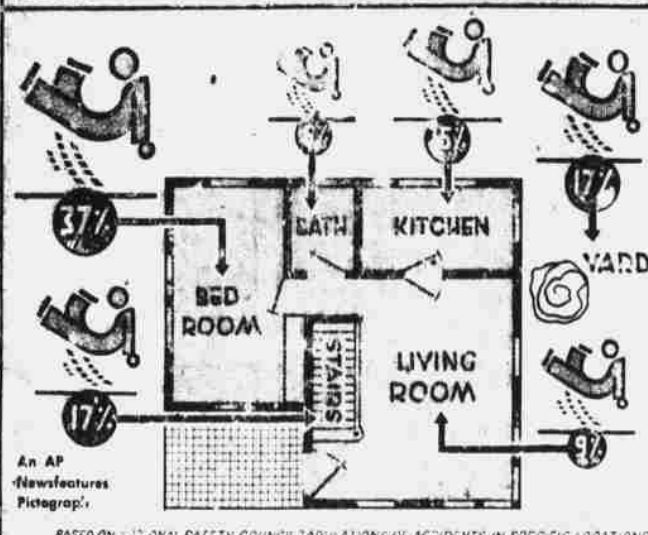

Bern, spent Wednesday afternoon with Mrs. M. Ca. Lyle Taylor. Mrs. Ashby B. Morton spent Friday with friends in Beaufort. Joel Davis motored to Morehead City Friday afternoon for his mother, Mrs. Harry Davis, who had been visiting Mrs. D. G. Bell. Mrs. Emma Oglesby spent Monday night with Mrs. Primrose Gooding at North River.

Mrs. Ashby B. Morton spent Tuesday afternoon at Beaufort with Mrs. Claude Taylor. Carlisle Taylor spent Friday in Rocky Mount. He was accompanied by Claude Taylor of Beaufort. Mrs. Vernon Lee Hancock, Miss Eleanor Jarman and Mrs. Jurney Conner were in Beaufort Saturday.

Mrs. Clyde S. Taylor was in Beaufort Friday evening. Carlisle Taylor and Douglas Williams were in New Bern Thursday on business.

Mr. and Mrs. W. Kuch Williams motored to Beaufort Saturday morning.

Mrs. Carlton Taylor was in New Bern Wednesday. She was accompanied by Mrs. James I. Smith, Jr., of Beaufort.

Mrs. Ale Taylor and Preston Taylor were in Morehead City Thursday. Miss Marie Smith, of Beaufort, visited Miss Jean Ball during the weekend.

Alex Taylor and Will Hardisty were in New Bern Friday morning on business.

Mrs. Gen. W. Bell and Mrs. Charlie Bell were in Morehead City Friday for Mrs. Bell to see a dentist.

Allen Taylor, of Morehead City, was here Friday afternoon to see Alex Taylor, his brother. Mrs. Roy Mason, Mrs. Xenophon Mason and son, Charles were in Beaufort Friday afternoon. The Woman's Society of Christian service met Friday evening with Mrs. Emma Oglesby. The program — "Advance Clipper" was combined to the regular program. The program was given by all the

noon to see Mr. and Mrs. Luke ... Mr. and Mrs. Claude Taylor and daughters, Jean, Claudie and Susan, of Beaufort, visited Mr. and Mrs. Ashby Morton Sunday afternoon. Fletcher Taylor, of Beaufort, passed through Friday enroute to Morehead City to see Rodman Taylor patient at the hospital. Mr. and Mrs. Luke Turner and Eddie, of Core Creek, visited Mrs. A. N. Bell Sunday evening.

SMYRNA
 Jan. 11 — Captain Earl Davis gave an oyster roast Saturday afternoon at his home near the river. Quite a number of his friends enjoyed the oysters. Miss Peggy Matthews, of Rocky Mount, spent the weekend here with her aunt and uncle, Mr. and Mrs. W. D. Pake.

Mrs. Hugh Willis, who was quite ill Friday night, is better at this time. Mrs. E. T. Piner, of Marshallberg, visited Mr. Piner's mother here a short time after church Sunday night.

Mr. and Mrs. Will Phillips and Mr. and Mrs. Henry Edwards, of Potosi, spent Sunday here with Mrs. Edwards' sister, Mrs. Mary Matthews and Mrs. Dorothy Pake. Mrs. Nina Wade of Beaufort, spent Sunday here with her sister, Mrs. J. B. Davis.

Mrs. Elouse Adams, of Morehead City, was here a few hours Sunday afternoon.

The Methodist Youth Fellowship held their regular meeting at the Methodist church here Sunday night. Captain H. C. Willis, Mr. W. L. Smith, Mr. E. T. Piner and D. V. Wade spent last week at

FRESH CAUGHT
Sea Foods
DRESSED & DELIVERED
 Phone M-401-1
 M-402-1
 Call on us today if you want information on fishing boats for charter or order of dressed fish.
OTTIS' MOREHEAD CITY FISH MARKET

Harbor Island on a hunting expedition. Mrs. Mamie Nelson, of Atlantic, spent some time here last week with her cousin, Mrs. Jettie Willis, both Mrs. Nelson and Mrs. Willis spent a day and night in Beaufort, visiting Mr. and Mrs. Leon Simon and Mr. and Mrs. Rumley Gilikin. Mr. and Mrs. Guy Lewis and family are moving in with Mr. Lewis' mother, Mrs. Laura Lewis to spend the winter. Mrs. Lewis has been quite sick for some time, also his brother, Mr. Winfield Gilikin, who has been spending some time with his sister, Mrs. Lewis, is sick.

Roof Deal Put on Ice
 COLUMBIA FALLS, Mont. — Mayor John O'Connell spared the treasury in a deal with 15 high school students. They put a roof on the new town hall and he arranged to have a skating rink flooded for them.

DELICIOUS Home Made Baked Goods For Sale
TOMCROW AT 9:30 A. M.
At Downum's Store
 Front Street, Beaufort
 Sponsored by the Young People's Class of Ann Street Methodist Sunday School
COME EARLY-BUY THE BEST

Home Style - Sandwich Regular Pan
MARVEL BREAD
 1 1/2-Lb. Loaf **18c**

VISIT YOUR FRIENDLY A&P FOR NUTRITIOUS DRIED FRUITS
 Apples Fancy Rings of Peeled and Cored Apples . . . 1-Lb. Pkg. 37c
 Apricots Ruddy in Color Fine in Flavor . . . 1-Lb. Pkg. 39c
 Prunes Tender, Meaty and Sweet California Large . . . 1-Lb. Pkg. 24c
 Peaches Perfectly Ripe Excellent Flavor . . . 1-Lb. Pkg. 33c
 A & P Prunes Large Clean Santa Clara . . . 1-Lb. Pkg. 22c
 Del Monte Plump, Tender Skinned PRUNES . . . 1-Lb. Pkg. 24c

A&P
 ESTABLISHED 1899
FOOD STORES

- Iona Standard Pack Tomatoes . . . 2 No. 2 Cans 29c
- Peaches . . . No. 2 29c
- Fine Flavor Iona Peas . . . 2 No. 2 Cans 22c
- A&P Golden Corn . . . No. 2 Can 19c
- Campbell's Tomato Soup . . . 2 10-Oz. Cans 21c
- Libby's Fruit Cocktail . . . No. 203 Can 29c
- Mild American Cheese . . . Lb. 50c
- Ann Page Spaghetti or Macaroni . . . 2 8-Oz. Pkgs. 19c
- White House Evap. Milk . . . 3 Tall Cans 39c
- Dried Pea Beans . . . 2-Lb. Pkg. 29c
- Shortening Swift Jewel . . . 1-Lb. Ctn. 28c
- Sunnyfield Self-Rising Flour . . . 10-Lb. Bag 81c
- A&P's Own Vegetable Shortening dexo . . . 3-Lb. Can \$1.05

ANN PAGE FOODS - A&P'S FINEST
 Ann Page BEANS With Pork and Tomato Sauce 16-Oz. Can 10c
 Ann Page Creamy Smooth PEANUT BUTTER 1-Lb. Jar 35c
 Ann Page SALAD DRESSING Pt. Jar 29c
 Ann Page Gelatin Desserts SPARKLE . . . 3 Pkgs. 20c
 Ann Page Prepared SPAGHETTI . . . 2 15-Oz. Cans 25c
 Ann Page MAYONNAISE . . Pt. Jar 39c
 Ann Page GRAPE JAM . . . 2-Lb. Jar 39c

MILD AND MELLOW 8 O'CLOCK COFFEE
 1-Lb. Bag 40c • 3 Lb. Bag \$1.15
 Vigorous and Winery BOKAR 1-Lb. Bag 47c 3 Lb. Bag \$1.35

- Octagon SOAP 2 Lge. Bars 17c
- Octagon soap FLAKES Lge. Pkg. 33c
- Palmolive SOAP 2 Reg. Bogs 19c
- Super SUDS Lge. Pkg. 33c
- Palmolive SOAP 2 Bath Bars 27c
- Ajax CLEANSER Pkg. 11c
- Woodbury Facial SOAP 3 Bars 29c
- Cashmere Bouquet SOAP 2 Bars 21c

- SELECT CHUCK ROAST, Lb. 59c
- SHORT RIBS BEEF, Lb. 33c
- LOIN END PORK ROAST, Lb. 43c
- CENTER CUT PORK CHOPS, Lb. 59c
- MORREL PRIDE HOCKLESS SMOKED PICNICS, Lb. 45c
- DRESSED and DRAWN HENS and Fryers, Lb. 62c

GRAND TASTING, VALUE GIVING FRESH FRUITS and VEGETABLES

- 200s—216s GRANGES, 2-Doz. 47
- 46s CARROTS, 2-bunches 17c
- GRAPEFRUIT, 5 for 29c
- IDAHO Russet Potatoes, 10-Lbs. 63c
- GRAPES, 2-Lbs. 25c
- CABBAGE, 2-Lbs. 9c
- RUTABAGAS, 2-Lbs. 9c
- YELLOW ONIONS, Lb. 5c

LIST Your Taxes

Tax listing began Monday, January 3rd, 1949 and will continue to January 31st. All men subject to Poll Taxes and all property owners, real or personal, must list to avoid penalties which will positively be charged for failure to list.

DO NOT DELAY!

- List Takers — Carteret County
- BEAUFORT TWP. Fred R. Seeley, John D. Brooks
 - MERRIMON TWP. Peter Carroway
 - STRAITS TWP. Richard Letters
 - MARSHALLBERG TWP. James C. Davis
 - ATLANTIC & SEALEVEL Walter Smith
 - CEDAR ISLAND Mrs. Bora Day
 - MOREHEAD TWP. Chas. V. Webb
 - WHITE OAK TWP. Sam Meadows
 - NEWPORT TWP. Prentice Garner
 - HARLOWE TWP. J. Raymond Ball
 - HARKERS ISLAND Mrs. Mabel Davis
 - DAVIS and STACY Hamlin Davis

JAMES B. POTTER
 Tax Supervisor — Beaufort, N. C.

QUALITY FOOD STORES PENDER QUALITY FOOD STORES

- DOWN PRODUCE LANE U. S. NO. 1**
White Potatoes 10-Lbs. 43c
- ALL SIZES JUICY
 FLORIDA ORANGES, 5-Lbs. 25c
 OREGON STATE BOSC FANCY PEARS, 2-Lbs. 21c
 FLORIDA HARD HEAD FRESH CABBAGE, Lb. 5c

- MRS. FILBERTS MARGARINE, 1-Lb. 38c
 LIBBY'S VIENNA SAUSAGE, No. 1-2 Can 21c
 GOLD LABEL COFFEE, 1-Lb. Pkg. 47c
 GOLD SEAL GLASS WAX, Pr. 59c
 SPRY SHORTENING, 3-Lbs. Can \$1.15
 CONVERTED RICE UNCLE BEN'S, Pkg. 24c
 REDGATE SLICED PEACHES, No. 2 1-2 Can 29c

SERVE WITH PORK—WHITE HOUSE
 Apple Sauce, 2 No. 303 Cans . . . 25c
 RED VINE RIPENED C S Tomatoes, No. 2 Can . . . 27c
 FOR SALADS—KRAFT'S Mayonnaise, 16-Oz. Jar . . . 47c
 FOR BISCUITS—SELF RISING C S Flour, 5-Lbs. Bag . . . 50c
 WHOLE KERNEL GOLDEN BANTAM Larsen's Corn, 141-2 Oz. Can . . . 23c
 IDEAL FOR SALADS—LIBBY'S Potted Meat, 5 1-2 Oz. Can . . . 16c
 DELICIOUS—SUPERFINE Lima Grands, No. 2 Can . . . 21c

GUARANTEED MEATS
 RIB OR LOIN END **Pork Roast LB. 41c**

CENTER CUT PORK CHOPS, Lb. 61c
 TENDER—JUICY CHUCK ROAST, Lb. 51c
 MADE FRESH—SOLD FRESH GROUND BEEF, Lb. 55c

- SANDWICH BREAD**
Our Pride 16-Oz. Loaf 14c
- PRESTON**
Lima Beans No. 2 Can 29c
- CHOCOLATE COVERED CHEERIES, 1-Lb. Box 65c
 TOILET TISSUE AMBASSADOR, Roll 9c
 ALASKAN CHUM SALMON, No. 1 can 53c
 REGULAR SIZE LUX SOAP, Cake 10c
 FOR DISHES SWAN SOAP, 2-Cakes 21c
 WHITER WASH RINSO, Lge. Pkg. 33c
 HEALTH SOAP LIFEBUOY, Cake 10c

These Prices Apply to Stores in Beaufort & Morehead